

道
〈MICH I〉

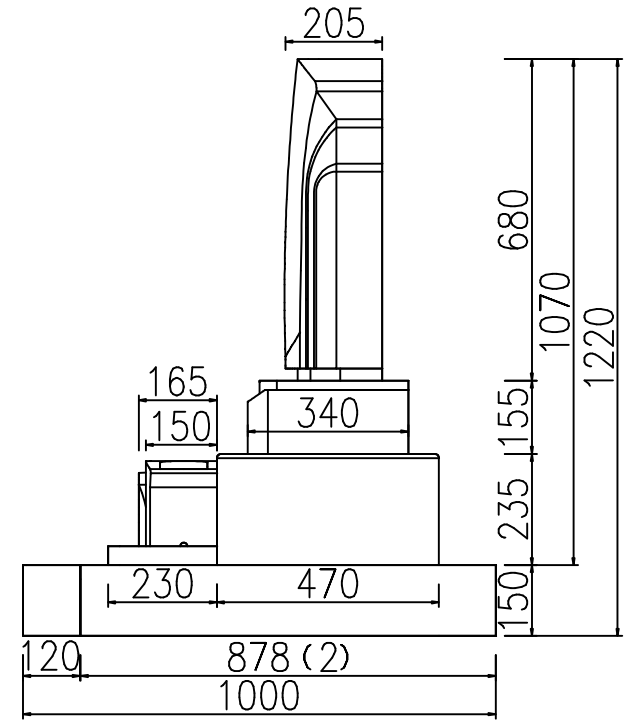

道
 < MICHI >

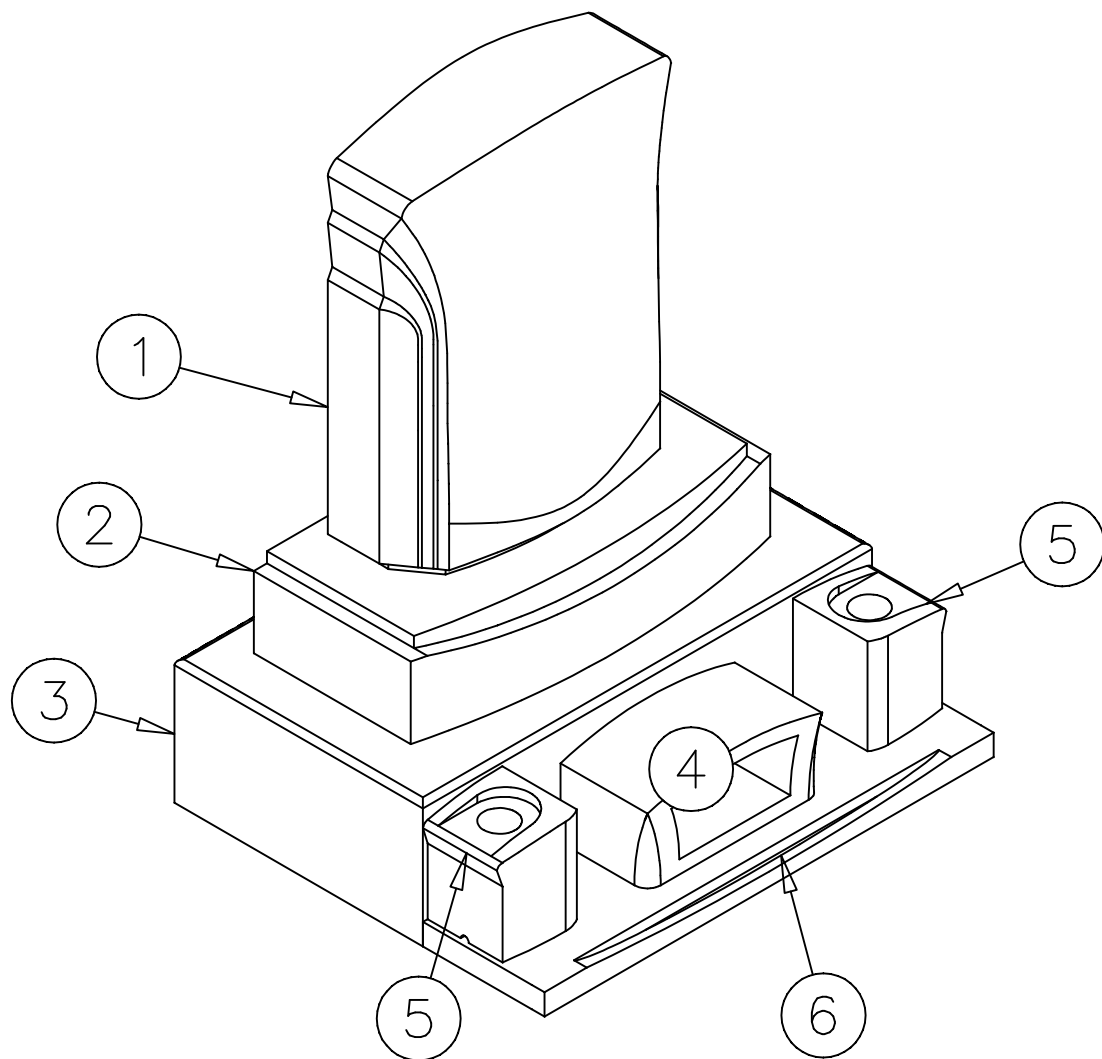

NO	製品	寸法(幅*奥行*高)			個数	才数
1	竿石	510	205	680	1	2.56
2	上台	680	340	155	1	1.29
3	下台	850	470	235	1	3.38
4	香炉	330	165	155	1	0.30
5	花立	150	150	180	2	0.29
6	板石	850	230	40	1	0.28
図面No. NA000-1837A					7	8.10

No.	1	名称	笄石	个数	1	仕上	△底場以外磨光
-----	---	----	----	----	---	----	---------

NA000-1837A

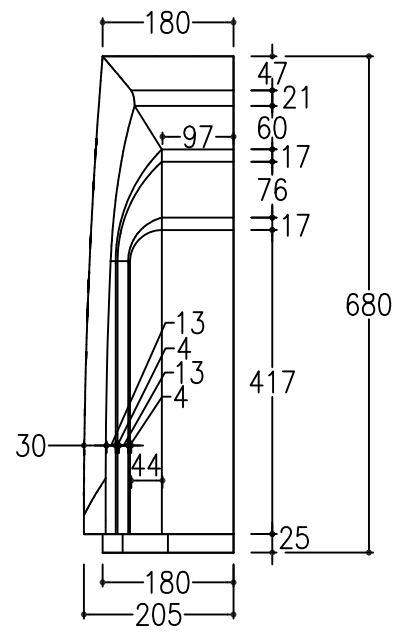
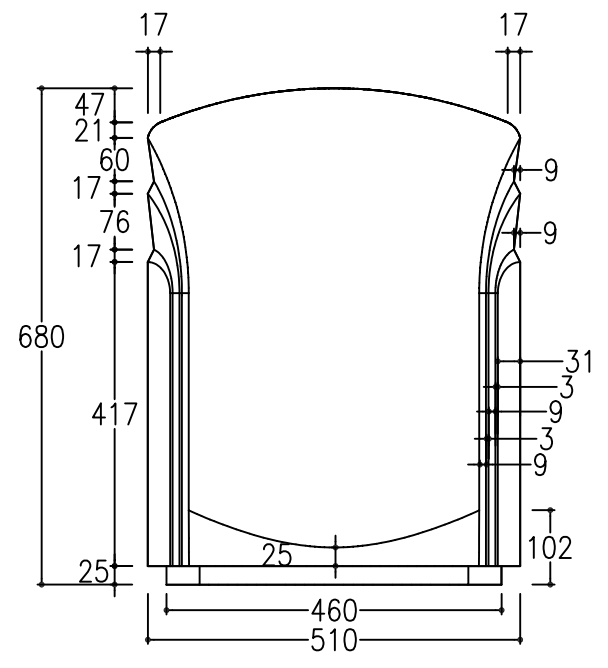
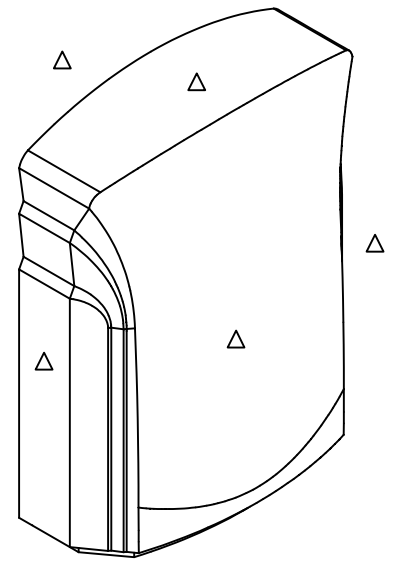
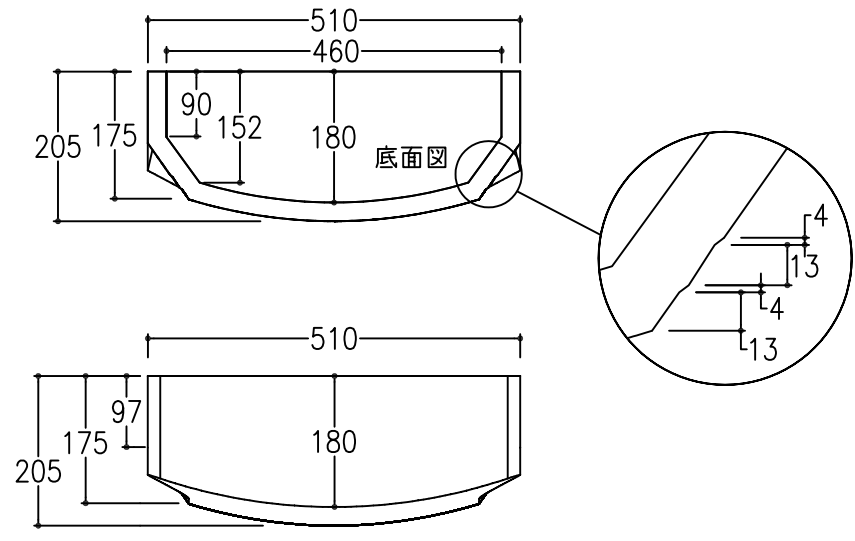

No.	2	名称	上台	個数	1	仕上	△底場以外磨光	No.	3	名称	下台	個数	1	仕上	△底場以外磨光
-----	---	----	----	----	---	----	---------	-----	---	----	----	----	---	----	---------

NA000-1837A

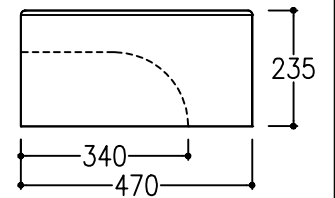
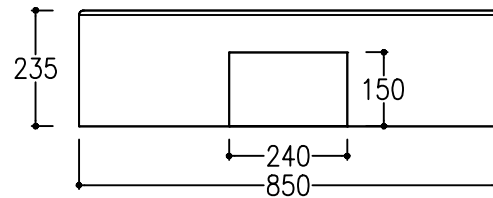
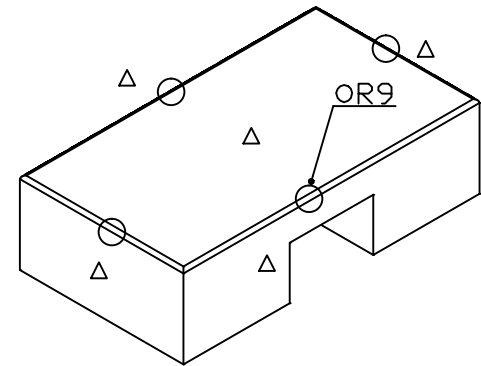
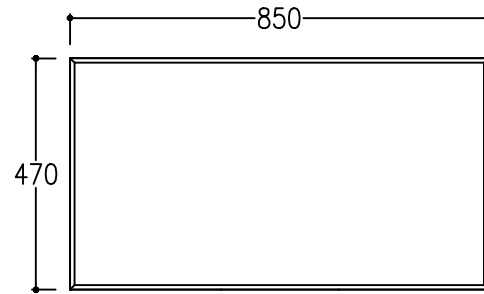
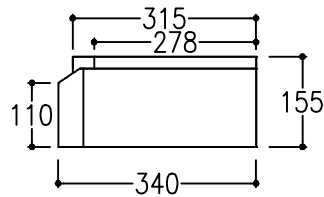
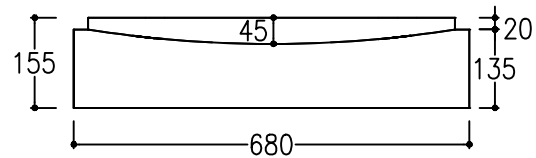
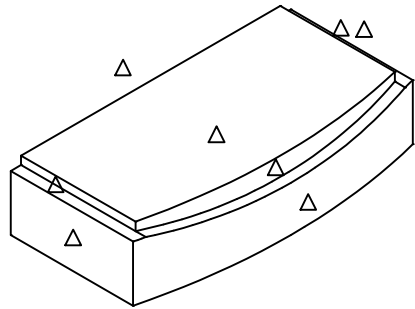
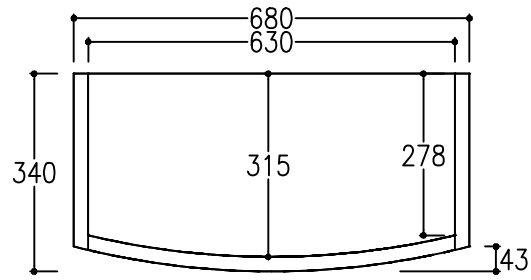

No.	4	名称	香炉	個数	1	仕上	△底場以外磨光	No.	6	名称	板石	個数	1	仕上	△底場以外磨光
-----	---	----	----	----	---	----	---------	-----	---	----	----	----	---	----	---------

NA000-1837A

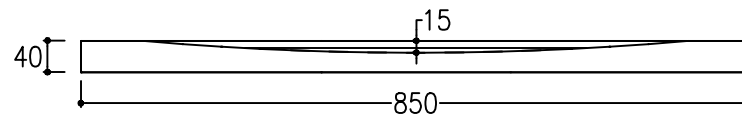
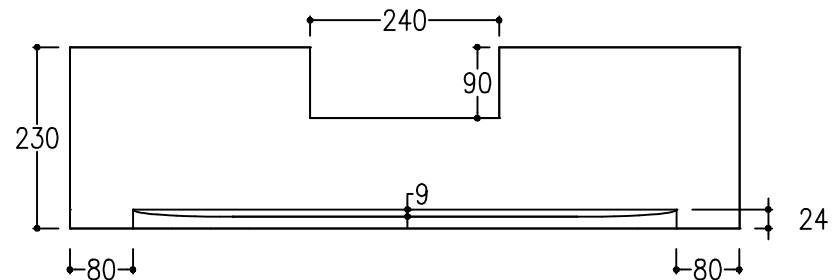
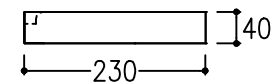
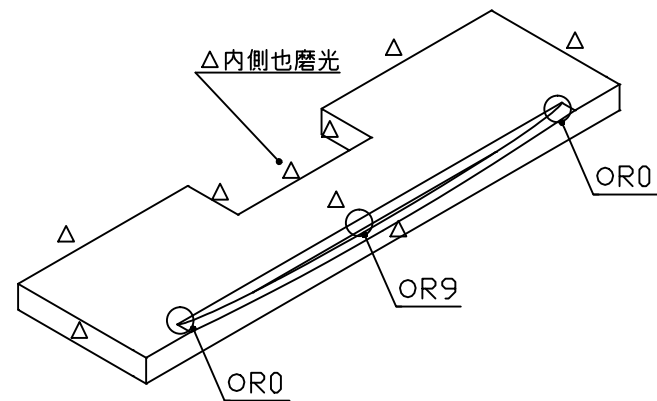
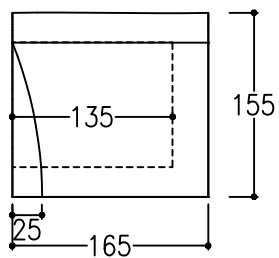
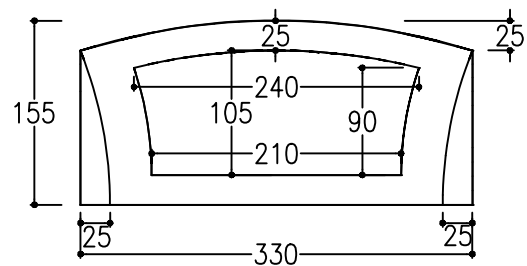
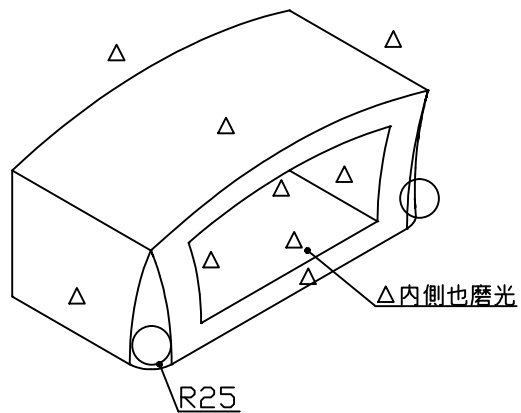
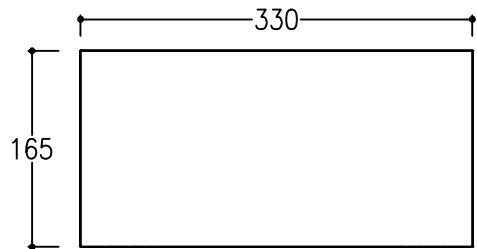

No.	5	名称	花立左	個数	1	仕上	△底場以外磨光	No.	6	名称	花立右	個数	1	仕上	△底場以外磨光
NA000-1837A															
<p>Technical drawing of part No. 5 (left). The top view shows a square with a rounded corner and a central circular hole of diameter $\phi 60$. Dimensions include a total width of 150, a hole diameter of 60, and a distance of 75 from the hole center to the right edge. The perspective view shows a water outlet hole with an outer diameter of $\phi 15$ and chamfered edges with a radius of OR9. The side view shows a height of 180 and a top width of 141.</p>								<p>Technical drawing of part No. 6 (right). The top view shows a square with a rounded corner and a central circular hole of diameter $\phi 60$. Dimensions include a total width of 150, a hole diameter of 60, and a distance of 75 from the hole center to the left edge. The perspective view shows a water outlet hole with an outer diameter of $\phi 15$ and chamfered edges with a radius of OR9. The side view shows a height of 180 and a top width of 141.</p>							
<p>Side view of part No. 5 showing a height of 180, a top width of 141, and a bottom width of 150. The top edge has a chamfer with a radius of 9 and a height of 17. A distance of 30 is shown from the top edge to the start of the main vertical section.</p>								<p>Side view of part No. 6 showing a height of 180, a top width of 141, and a bottom width of 150. The top edge has a chamfer with a radius of 9 and a height of 17. A distance of 30 is shown from the top edge to the start of the main vertical section.</p>							
<p>Side view of part No. 5 showing a height of 180, a top width of 150, and a bottom width of 141. The top edge has a chamfer with a radius of 9 and a height of 17. A distance of 30 is shown from the top edge to the start of the main vertical section.</p>								<p>Side view of part No. 6 showing a height of 180, a top width of 150, and a bottom width of 141. The top edge has a chamfer with a radius of 9 and a height of 17. A distance of 30 is shown from the top edge to the start of the main vertical section.</p>							

道
 < MICHI >

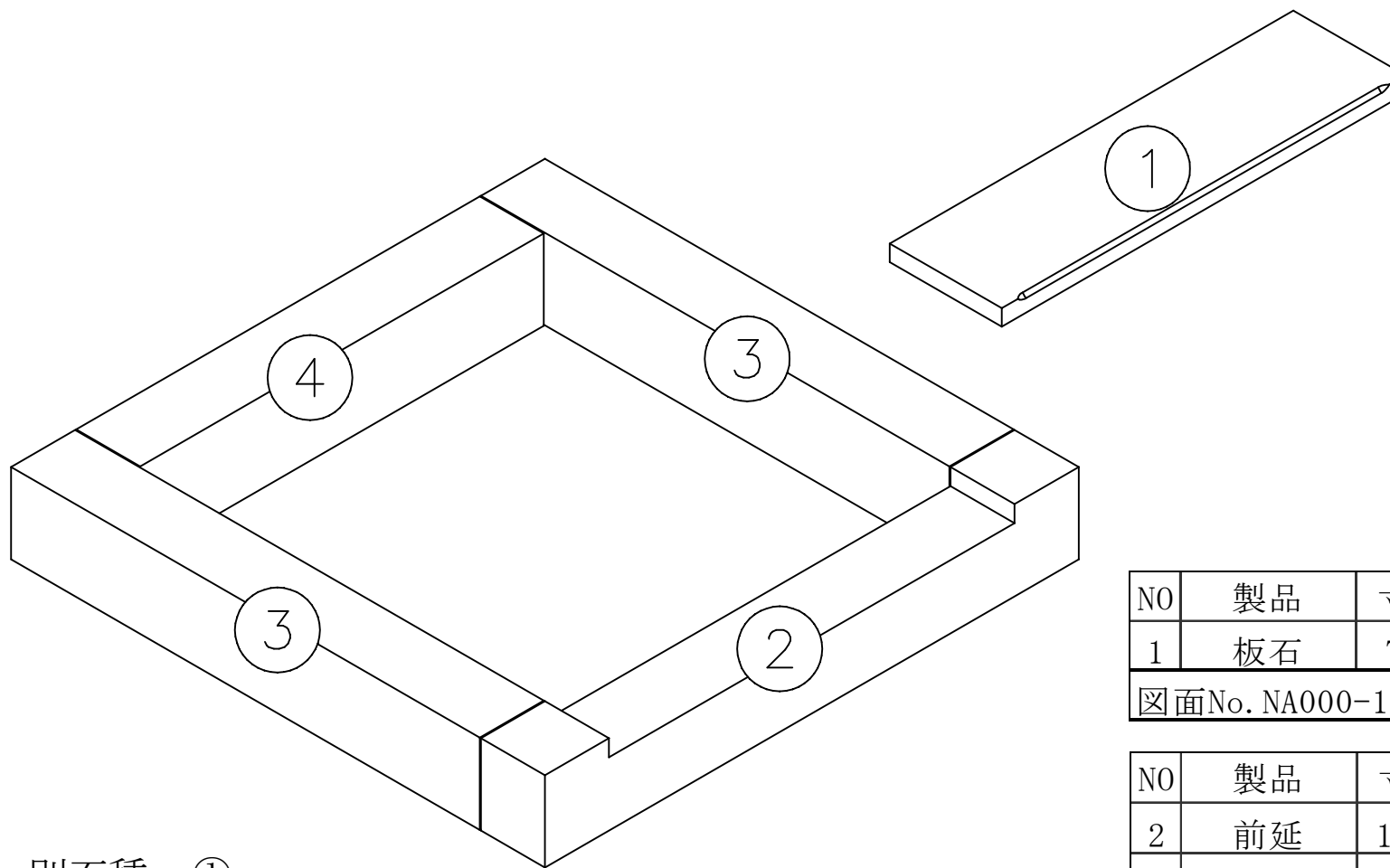

別石種：①

②～④

NO	製品	寸法 (幅*奥行*高)			個数	才数
1	板石	756	210	30	1	0.17
図面No. NA000-1837A					1	0.17

NO	製品	寸法 (幅*奥行*高)			個数	才数
2	前延	1000	120	150	1	0.65
3	横延	120	878	150	2	1.14
4	後延	756	120	150	1	0.49
図面No. NA000-1837A					4	2.28

No.	1	名称	板石	個数	1	仕上	3面磨	No.		名称		個数		仕上	
NA000-1837A															
<p>The drawing shows a 3D perspective view and a 2D top view of a rectangular plate. The 3D view includes the following annotations: <ul style="list-style-type: none"> \triangle 内側也磨光 (Inner side also polished) \circ 平面9 (Plane 9) Dimensions: 30 (width), 210 (length), 756 (4) (total length) </p> <p>The 2D top view shows the following dimensions: <ul style="list-style-type: none"> Length: 756 (4) Width: 210 End flange width: 30 (on both ends) </p>															

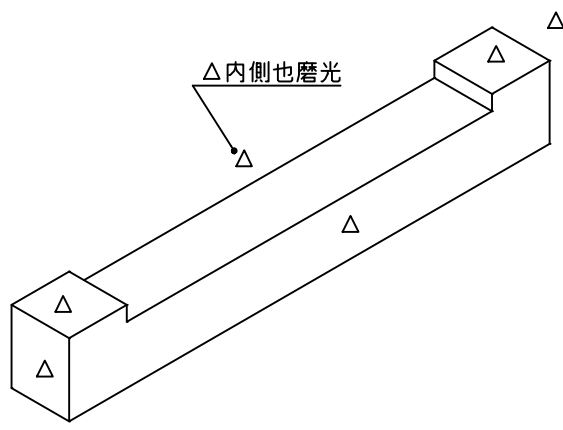
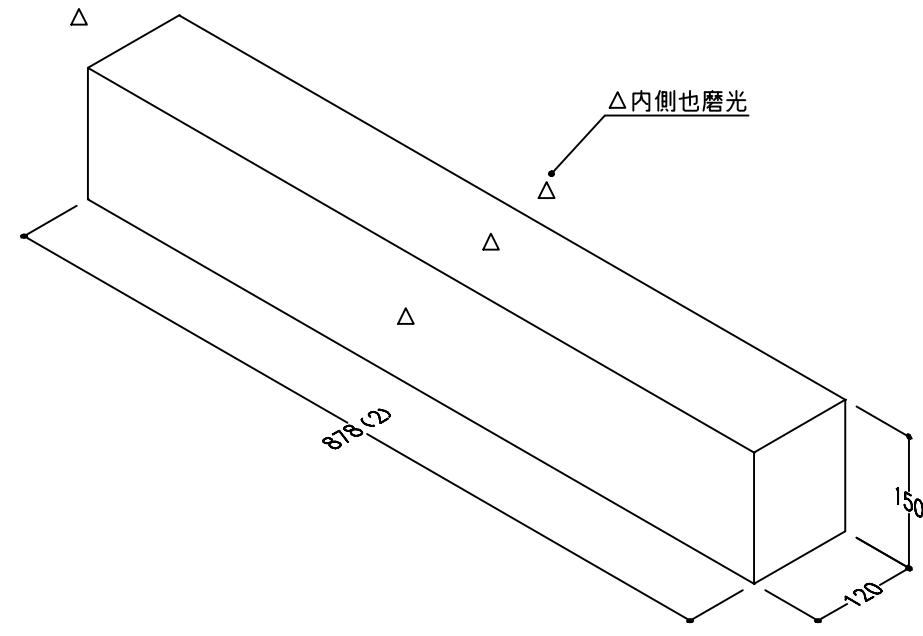
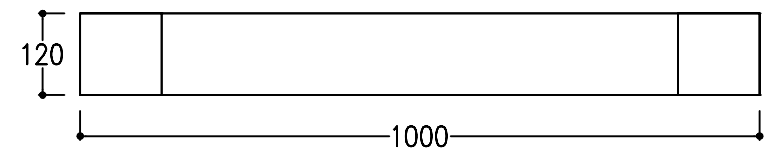
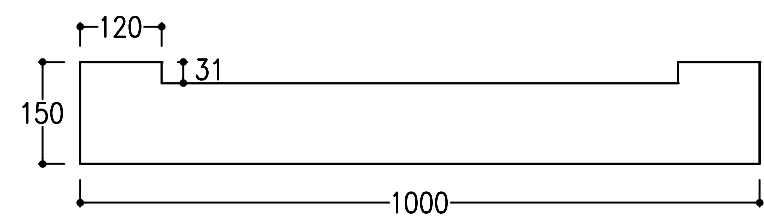
No.	2	名称	前延	個数	1	仕上	△底場以外磨光	No.	3	名称	横延	個数	2	仕上	4面磨
NA000-1837A															
															
															

No.	4	名称	後延	個数	1	仕上	3面磨	No.		名称		個数		仕上	
NA000-1837A															
<p>Technical drawing of a rectangular block. The dimensions are: width 120, length 150 (4), and height 150. Three triangular symbols (Δ) indicate the surfaces to be polished: the top surface, the front face, and the inner side face. A label 'Δ内側也磨光' (Polish inner side too) points to the inner side face.</p>															