

永遠  
 < TOWA >

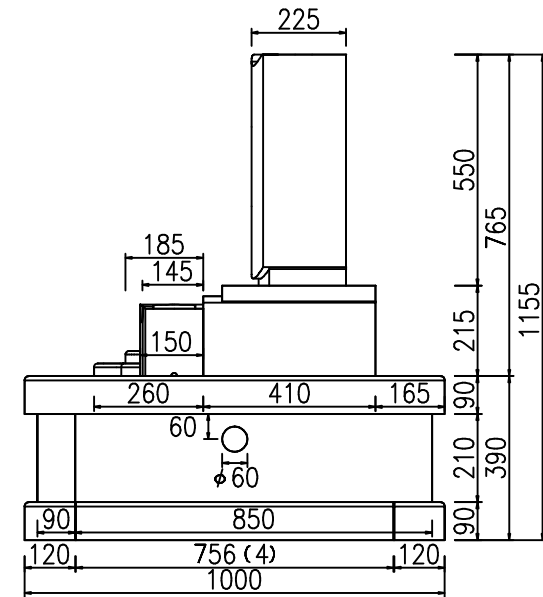

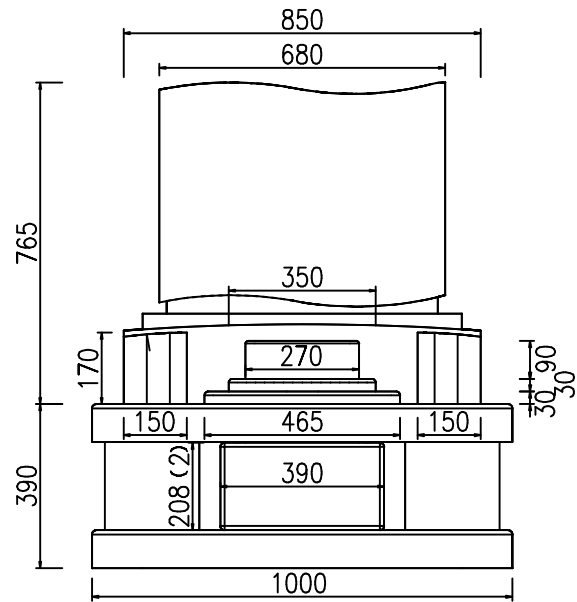
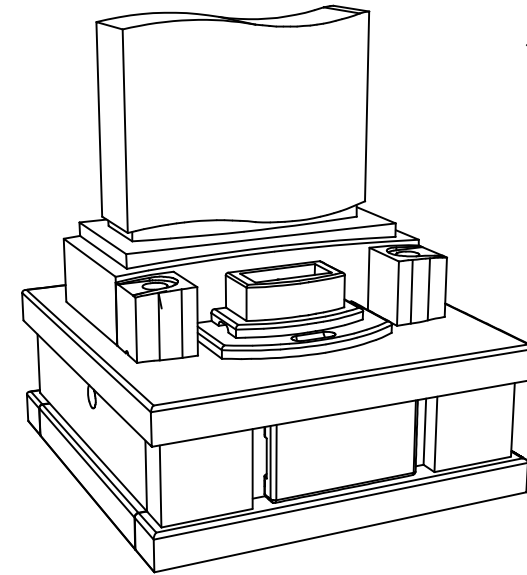
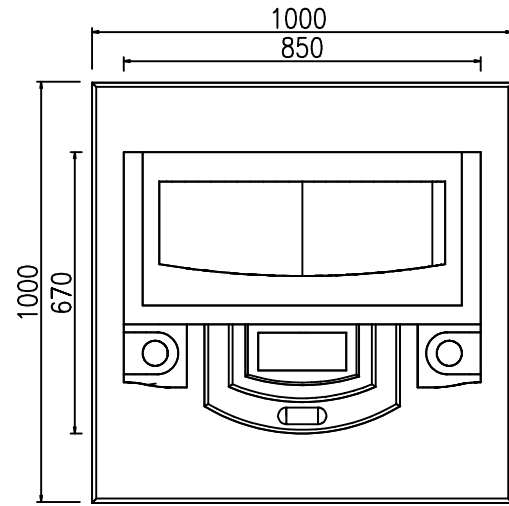
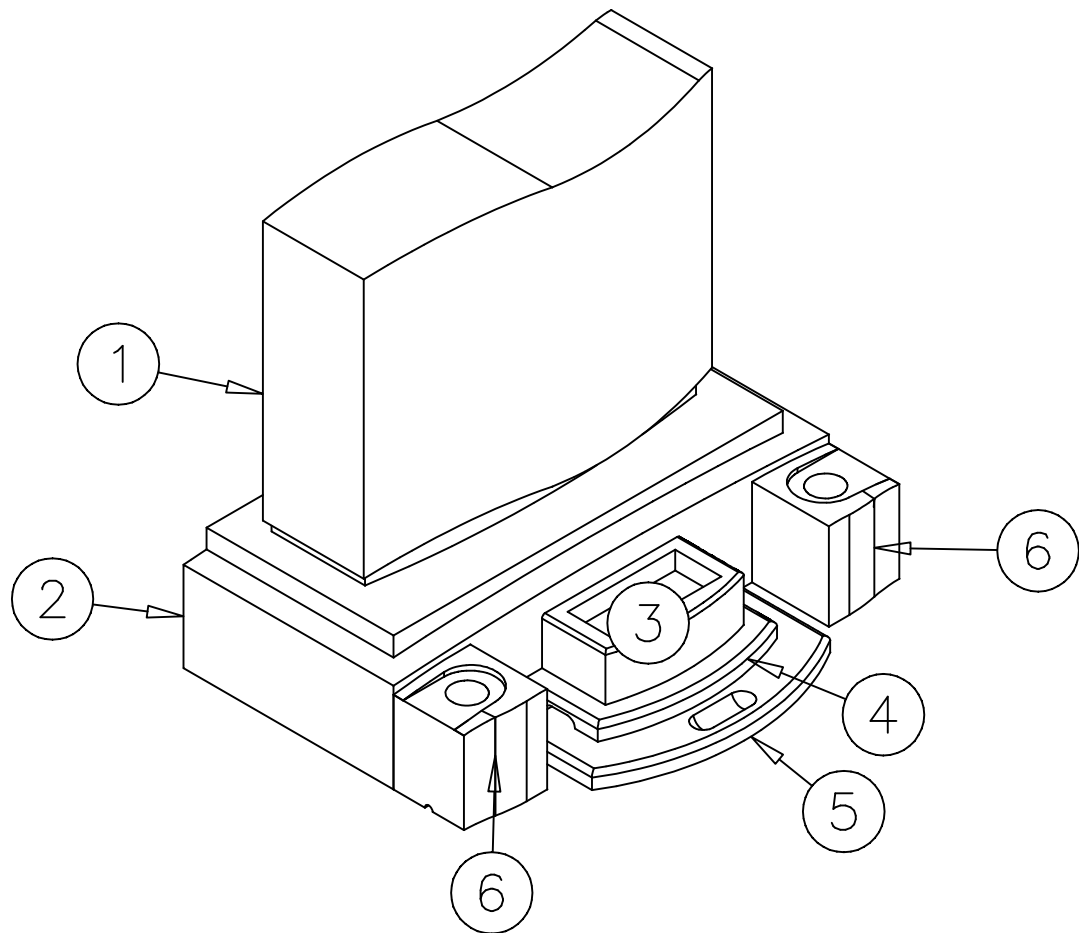

NO	製品	寸法 (幅*奥行*高)			個数	才数
1	竿石	680	225	550	1	3.03
2	下台	850	410	215	1	2.70
3	香炉	270	145	90	1	0.13
4	香炉台	350	185	30	1	0.07
5	水鉢	465	260	30	1	0.13
6	花立	150	150	170	2	0.28
図面No. NA000-1843D					7	6.34

No.	1	名称	竿	個数	1	仕上	△底場以外磨光	No.	2	名称	下台	個数	1	仕上	△底場以外磨光
		NA000-1843D													

No.	3	名称	香炉	个数	1	仕上	△底場以外磨光	No.	4	名称	香炉台	个数	1	仕上	△底場以外磨光
-----	---	----	----	----	---	----	---------	-----	---	----	-----	----	---	----	---------

NA000-1843D

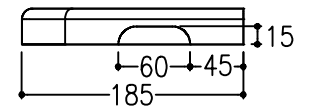
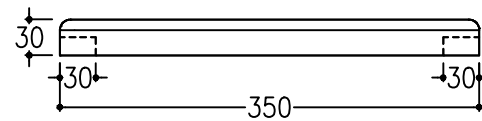
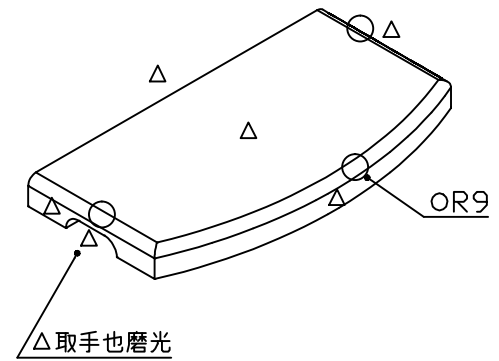
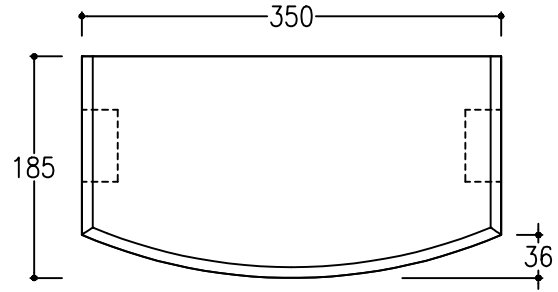
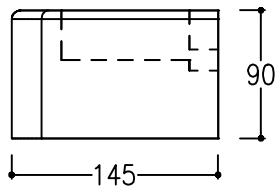
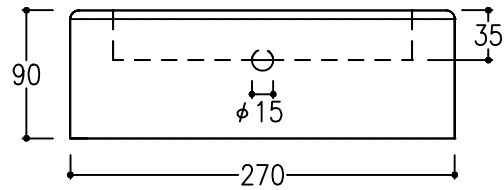
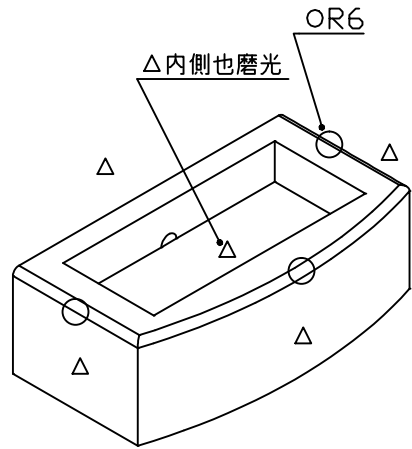
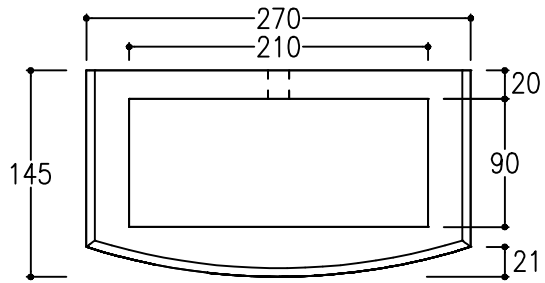

No.	5	名称	水鉢	個数	1	仕上	△底場以外磨光	No.	6	名称		個数	2	仕上	
NA000-1843D															
<p>Technical drawing of a water basin (No. 5). The drawing includes three views: a top view, a perspective view, and two side views.</p> <ul style="list-style-type: none"> <li><b>Top View:</b> Shows a rectangular basin with a curved bottom. Dimensions include a total width of 465, a total height of 260, and a bottom width of 115. A small rectangular feature at the bottom center has a width of 40 and a depth of 22.</li> <li><b>Perspective View:</b> Shows the basin from an angled view. The depth of the basin is labeled as 15. Several triangles (△) are placed around the basin to indicate areas for polishing.</li> <li><b>Side Views:</b> Two side views are shown. The left side view shows a total length of 465 and a thickness of 30. The right side view shows a total length of 260 and a thickness of 30.</li> </ul>															

No.	6	名称	花立 (左)	個数	1	仕上	△底場以外磨光	No.	6	名称	花立 (右)	個数	1	仕上	△底場以外磨光
-----	---	----	--------	----	---	----	---------	-----	---	----	--------	----	---	----	---------

NA000-1843D

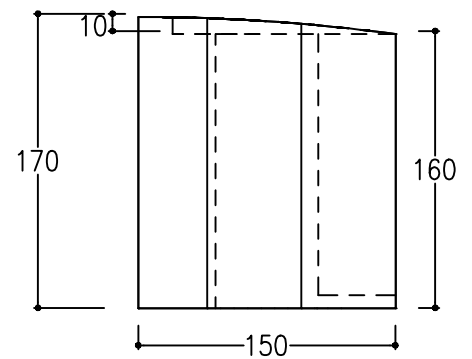
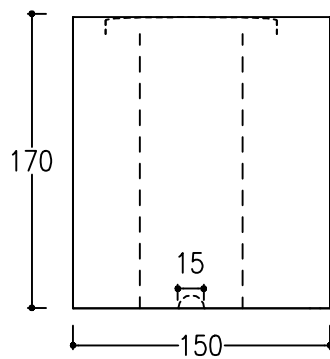
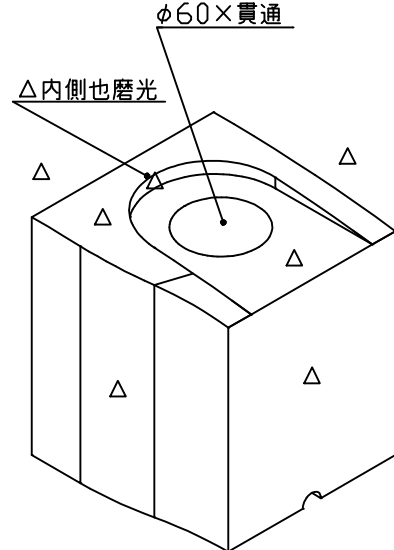
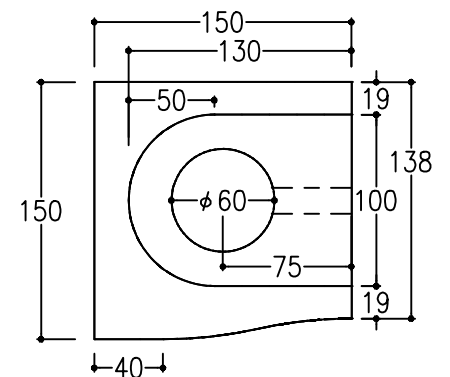
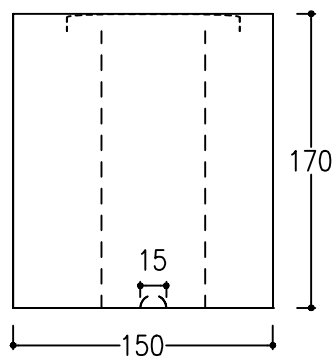
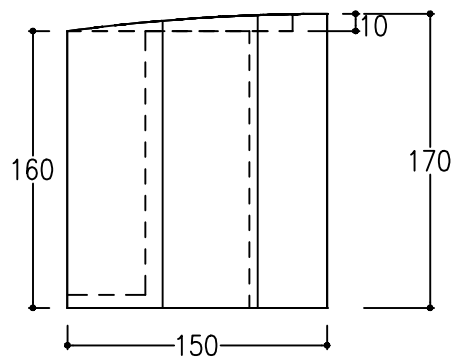
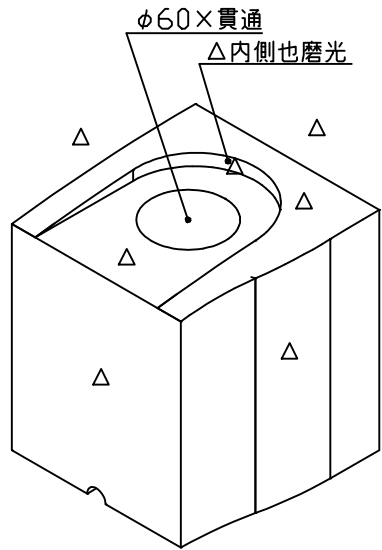
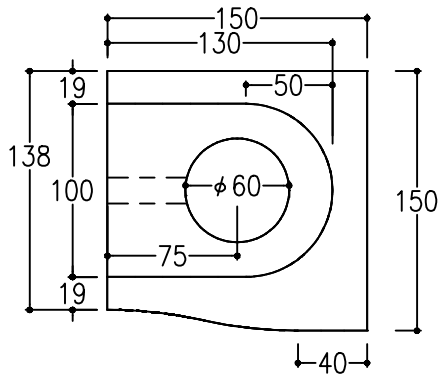

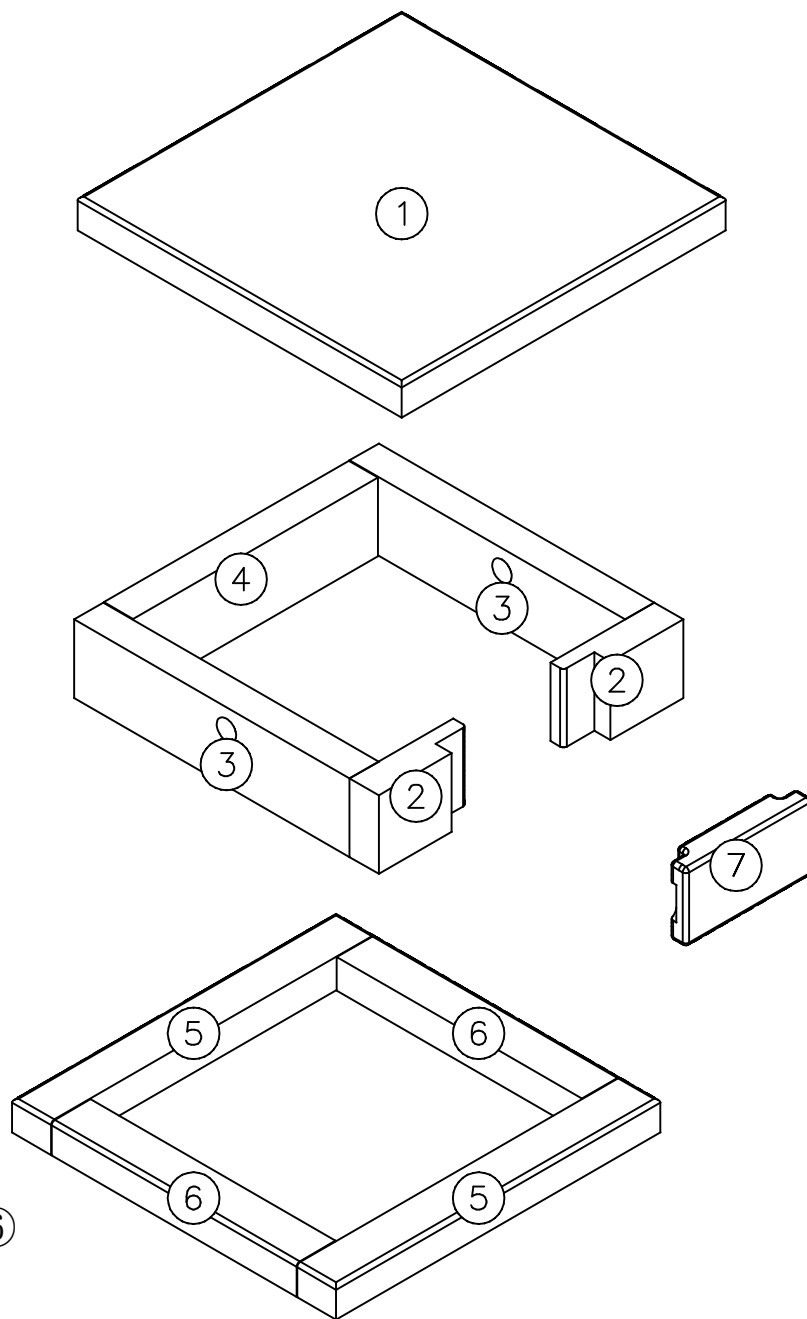

別石種：①～⑥  
⑦

NO	製品	寸法(幅*奥行*高)			個数	才数
1	天板	1000	1000	90	1	3.24
2	前板	320	90	210	2	0.44
3	横板	850	90	210	2	1.16
4	後板	756	90	210	1	0.51
5	四ッ石前後	1000	120	90	2	0.78
6	四ッ石横	120	756	90	2	0.59
図面No. NA000-1843D					10	6.72

NO	製品	寸法(幅*奥行*高)			個数	才数
7	納骨蓋	390	80	208	1	0.23
図面No. NA000-1843D					1	0.23

No.	1	名称	天板	個数	1	仕上	△全面磨光	No.	2	名称	前板	個数	2	仕上	4面磨	
NA000-1843D																



No.	3	名称	横板	個数	2	仕上	3面磨	No.	4	名称	後板	個数	1	仕上	2面磨	
NA000-1843D																

No.	5	名称	四ッ石 (前後)	個数	2	仕上	△底場以外磨光	No.	6	名称	四ッ石 (横)	個数	2	仕上	3面磨
-----	---	----	----------	----	---	----	---------	-----	---	----	---------	----	---	----	-----

NA000-1843D

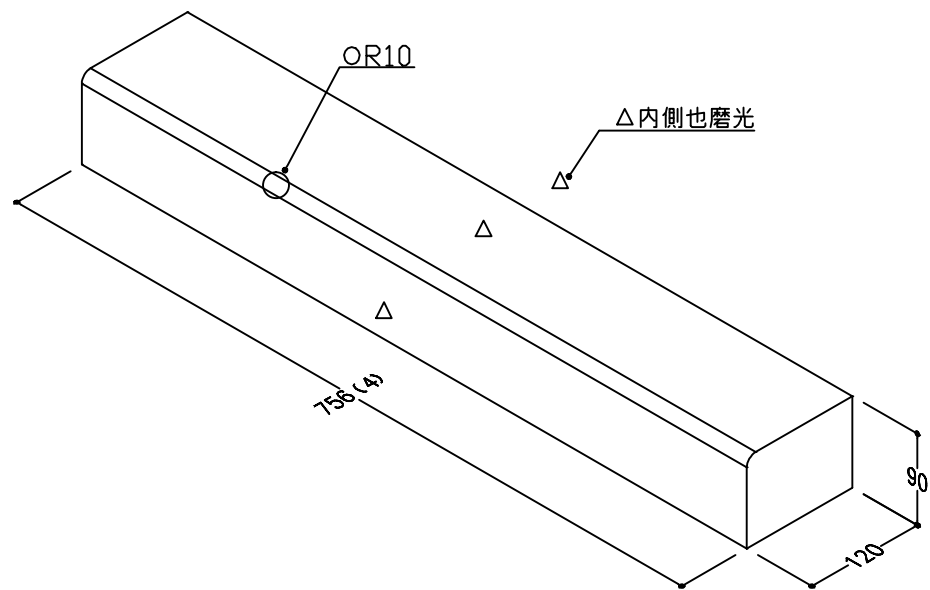
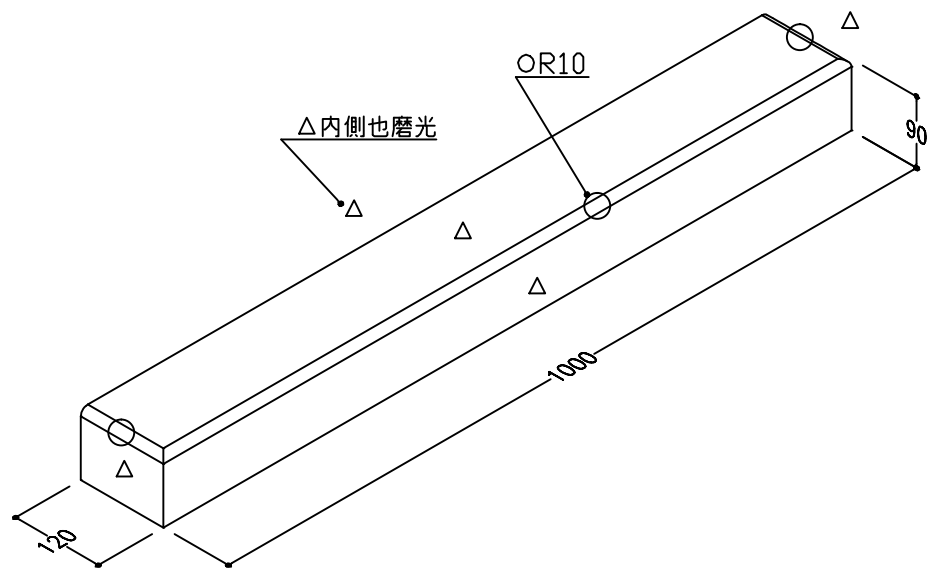

No.	7	名称	納骨蓋	個数	1	仕上	△全面磨光
-----	---	----	-----	----	---	----	-------

NA000-1843D

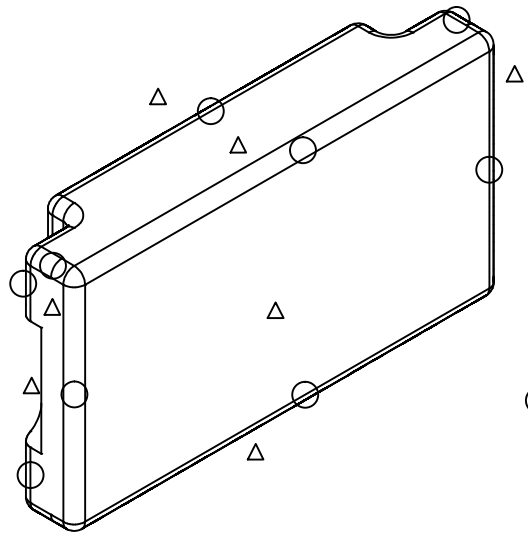
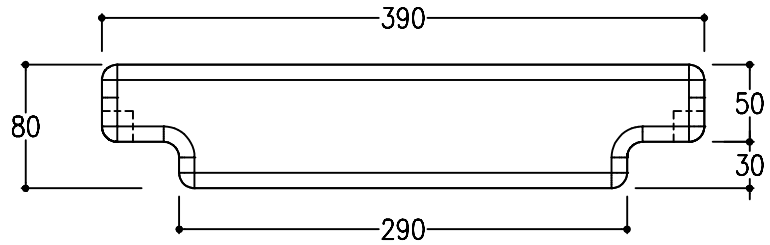

○印 全辺R10

