

やすらぎ
 < YASURAGI >

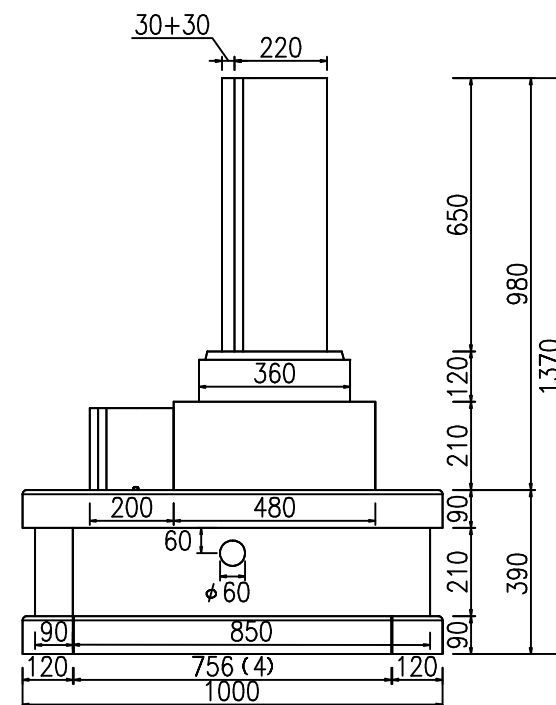

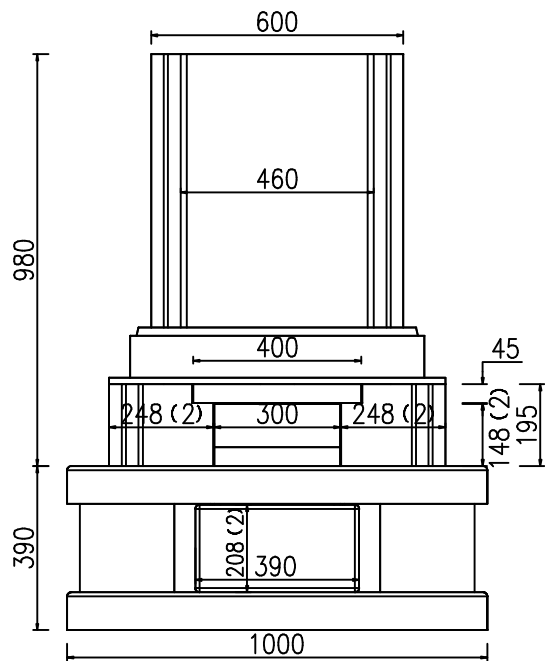
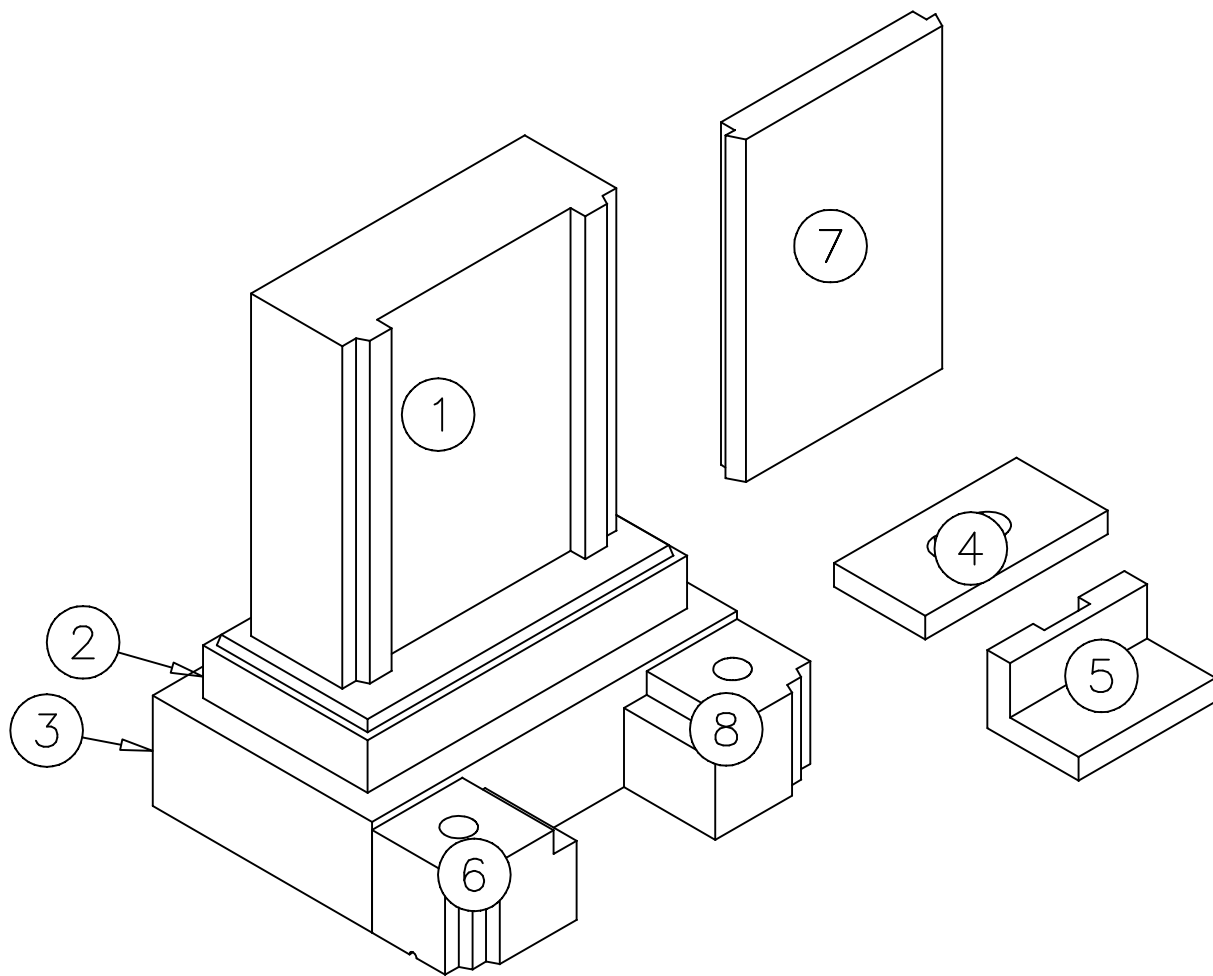

別石種：①～⑥
 ⑦

NO	製品	寸法(幅*奥行*高)			個数	才数
1	竿石	600	220	650	1	3.09
2	上台	700	360	120	1	1.09
3	下台	800	480	210	1	2.90
4	水鉢	400	200	45	1	0.13
5	香炉	300	200	148	1	0.32
6	花立	248	200	195	2	0.70
図面No. NA000-1743B					7	8.23

NO	製品	寸法(幅*奥行*高)			個数	才数
7	額	460	60	650	1	0.65
図面No. NA000-1743B					1	0.65

No.	1	名称	竿石	個数	1	仕上	△底場以外磨光	No.	2	名称	上台	個数	1	仕上	△底場以外磨光
-----	---	----	----	----	---	----	---------	-----	---	----	----	----	---	----	---------

NA000-1743B

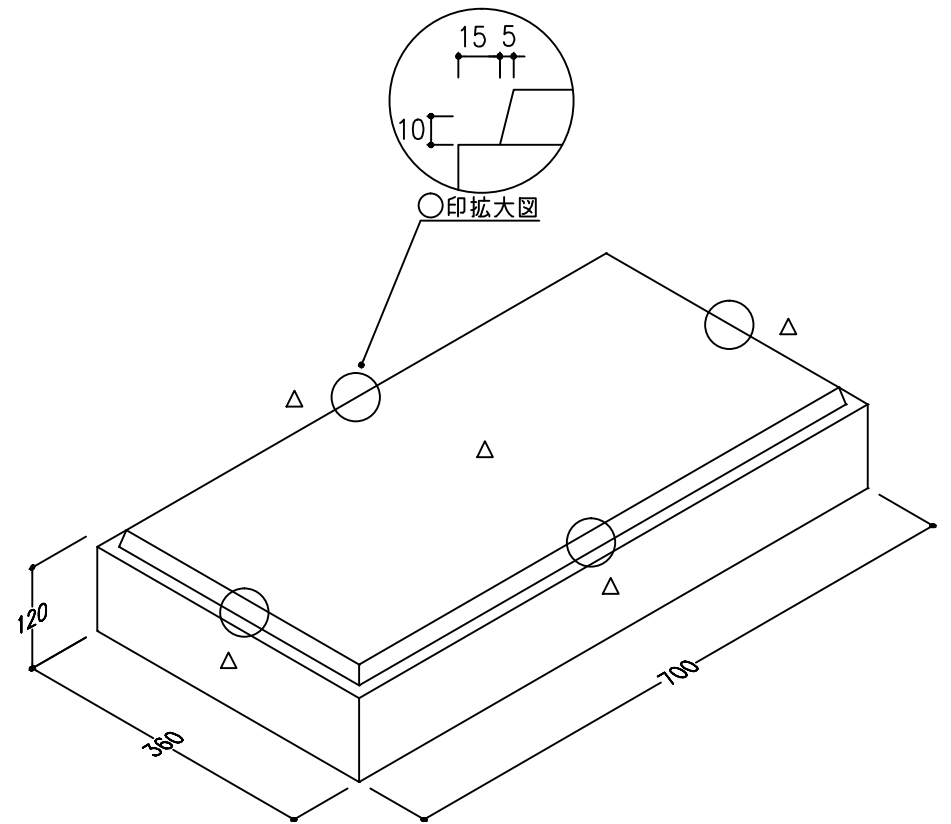
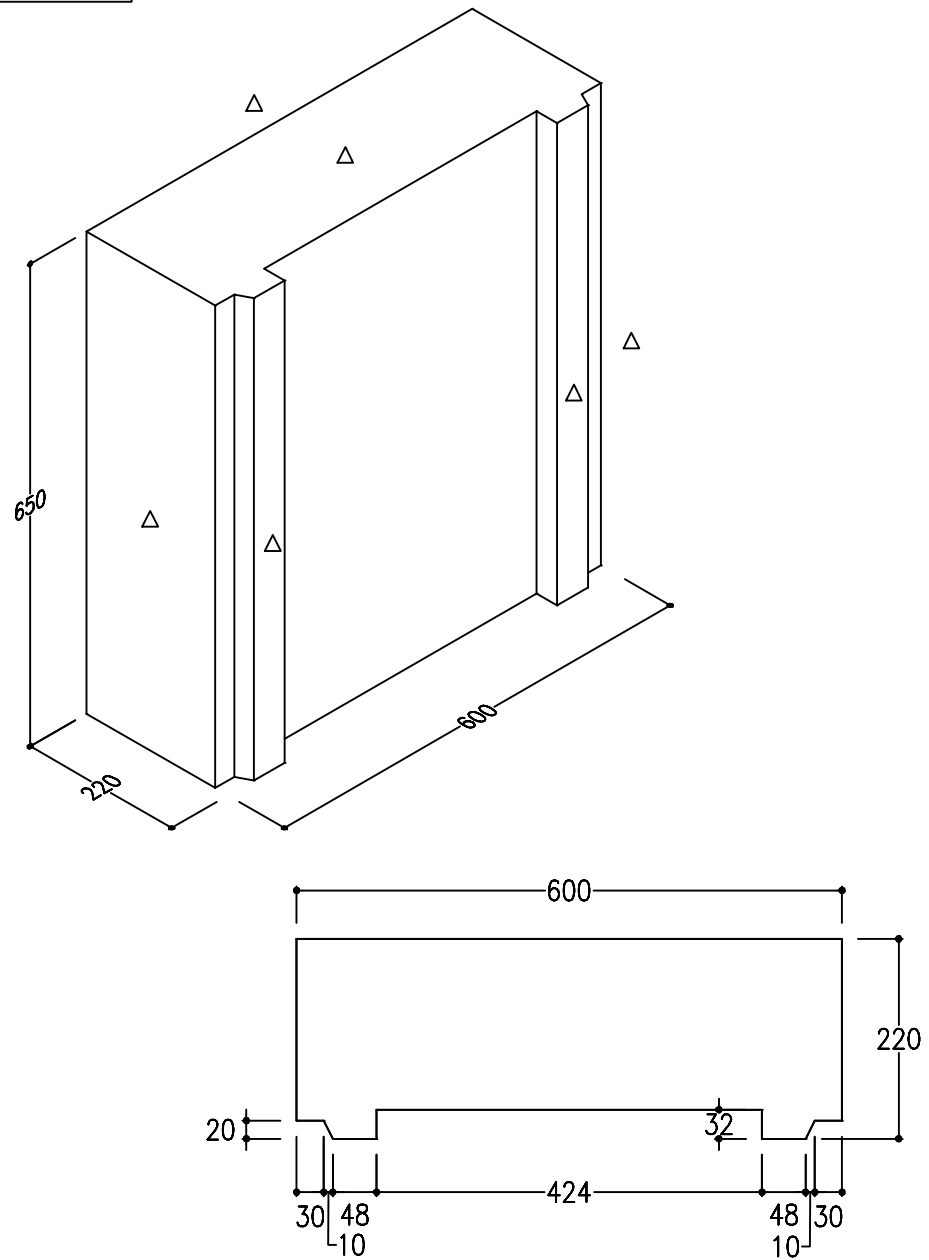

No.	3	名称	下台	個数	1	仕上	△底場以外磨光	No.	4	名称	水鉢	個数	1	仕上	△底場以外磨光
-----	---	----	----	----	---	----	---------	-----	---	----	----	----	---	----	---------

NA000-1743B

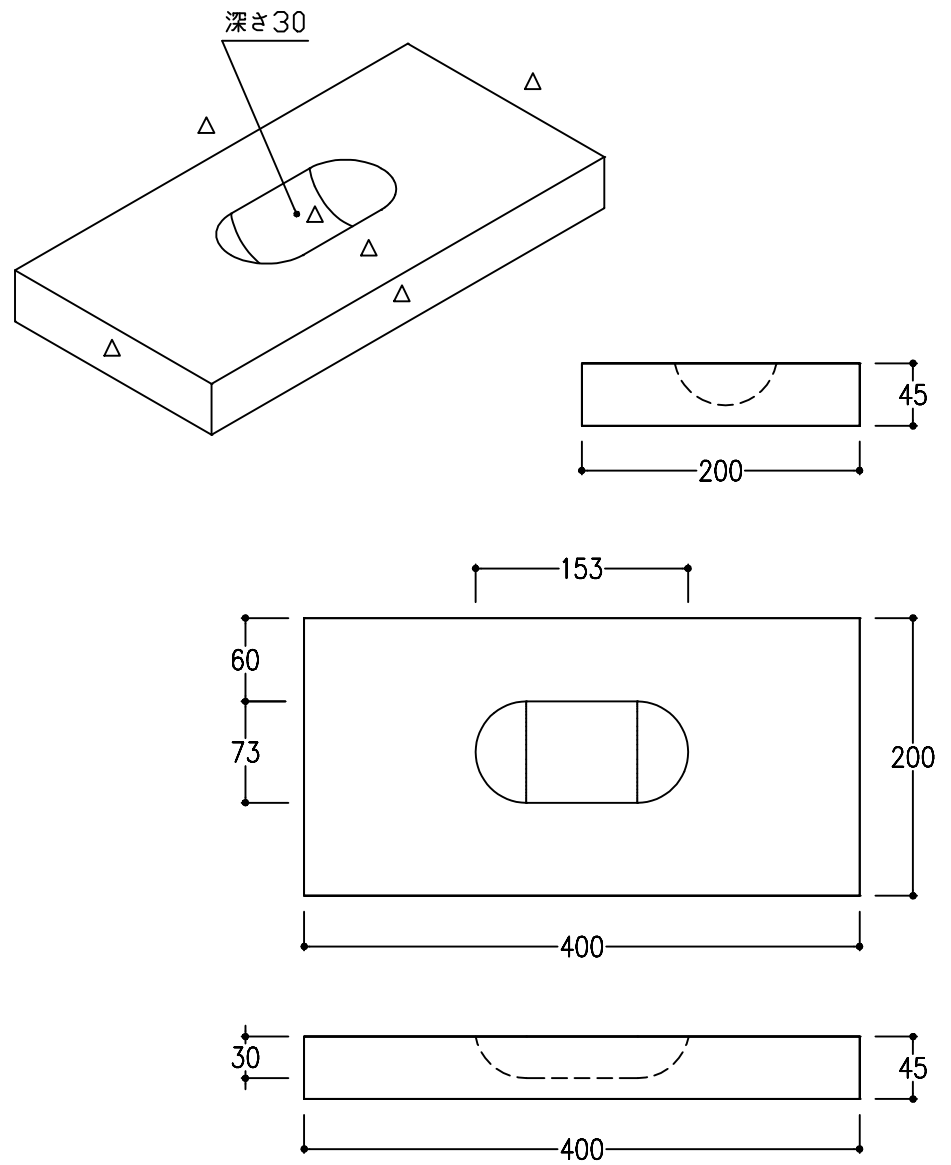
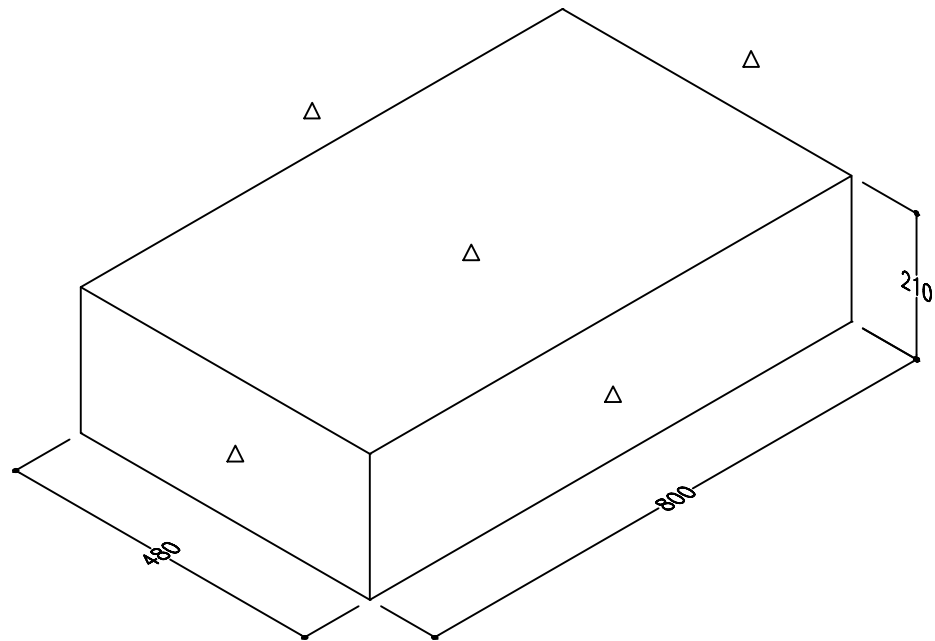

No.	5	名称	香炉	个数	1	仕上	△底場以外磨光	No.		名称		个数	2	仕上	
NA000-1743B															
<p>Technical drawing of a rectangular incense burner (香炉). The drawing includes a top view, a 3D perspective view, and a side view.</p> <p>Top View: Shows a rectangular base with a width of 300 and a height of 200. A smaller rectangular feature is located at the top center, with a width of 100 and a height of 25. The distance from the top edge of the base to the top edge of this feature is 150.</p> <p>3D Perspective View: Shows the burner with chamfered edges, indicated by small triangles (△). The base is 300 wide and 200 high. The top surface is 100 wide and 25 high.</p> <p>Side View: Shows the burner from the side. The total height is 148(2). The base width is 300. The top surface is 100 wide and 25 high. The distance from the top edge of the base to the top edge of this feature is 103(2). The distance from the top edge of the base to the top edge of the feature is 148(2).</p> <p>Detail View: Shows a detail of the top surface. The width is 50, the height is 30, and the distance from the top edge of the base to the top edge of this feature is 25. The total height is 148(2). The base width is 200.</p>															

No.	6	名称	花立(左)	个数	1	仕上	△底場以外磨光	No.	6	名称	花立(右)	个数	1	仕上	△底場以外磨光
-----	---	----	-------	----	---	----	---------	-----	---	----	-------	----	---	----	---------

NA000-1743B

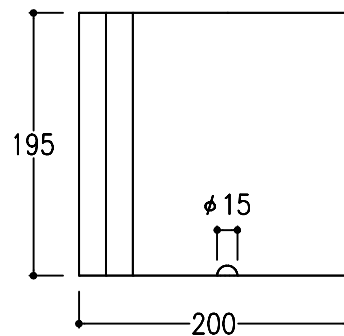
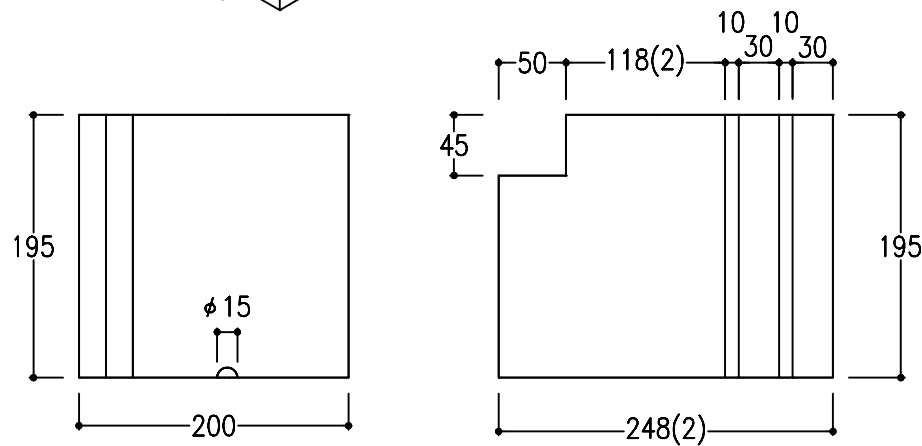
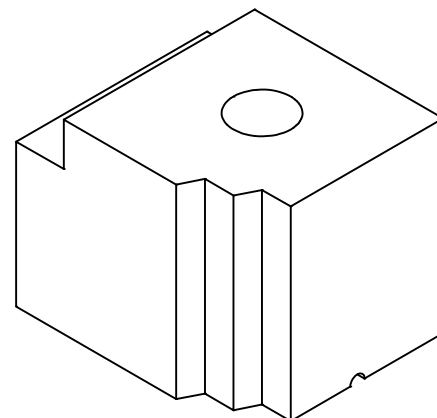
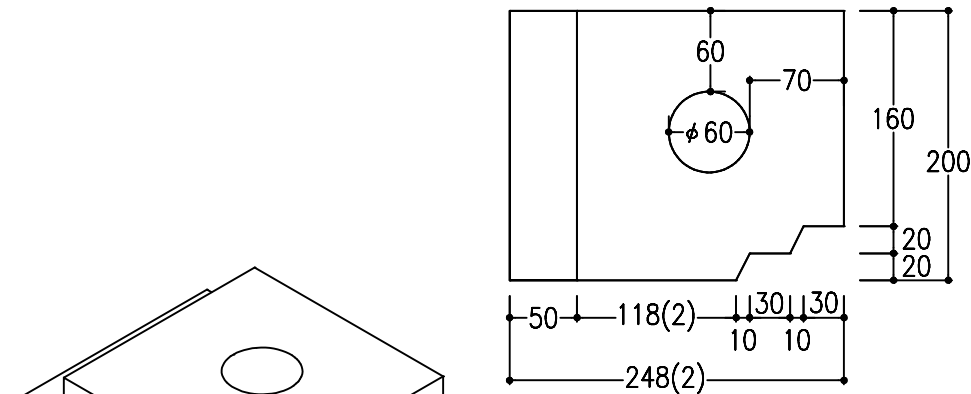
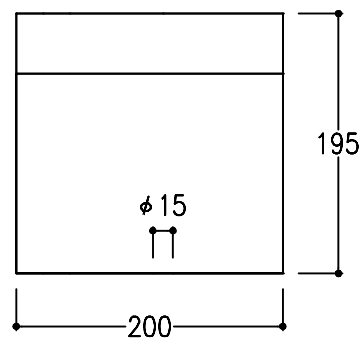
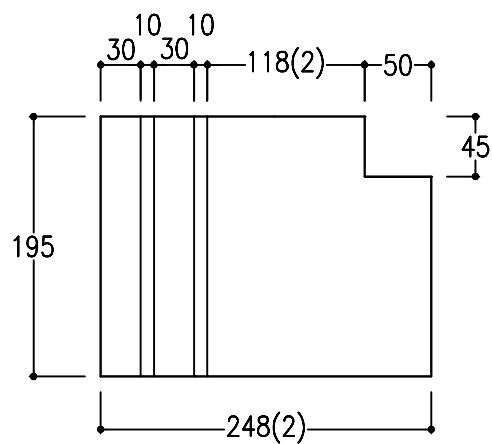
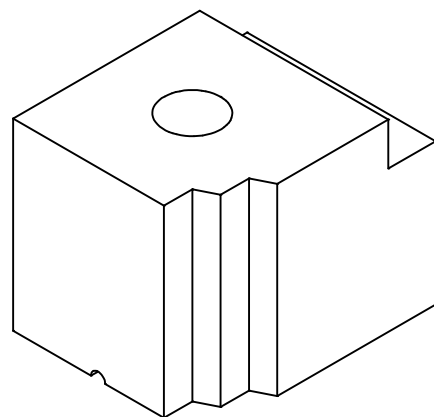
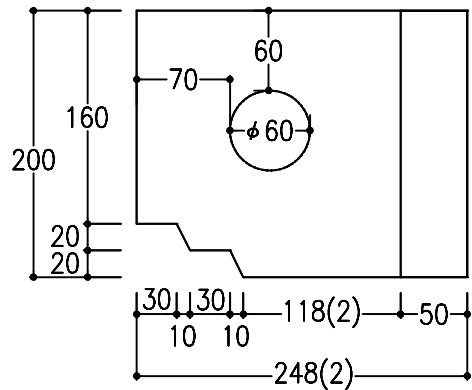

No.	7	名称	額	個数	1	仕上	4面磨	No.	名称	個数	仕上	
NA000-1743B												
<p>Technical drawing of a rectangular plate. The 3D view shows a plate with a height of 650 and a width of 480. The cross-section shows a total width of 430, with a central section of 420. The top edge has a 20mm wide section, and the bottom edge has a 15mm wide section. The thickness of the plate is 30mm.</p>												

やすらぎ
 < YASURAGI >

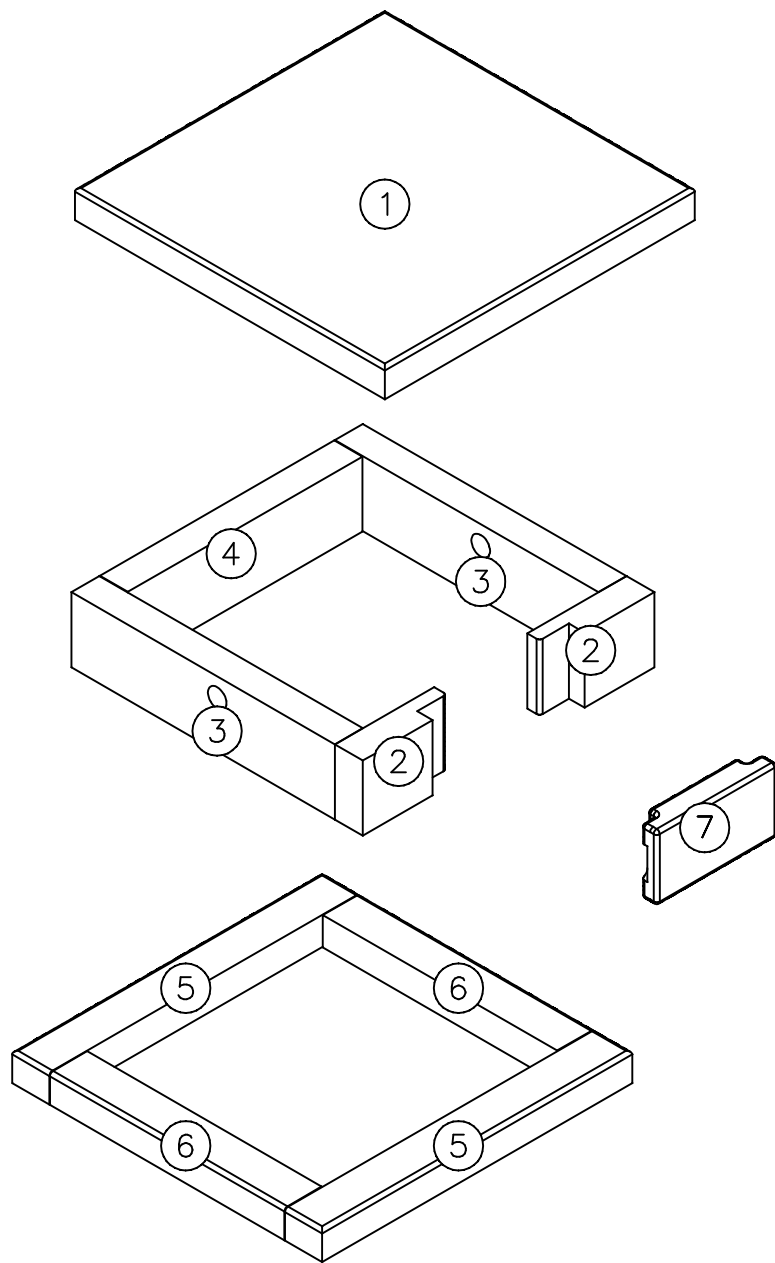

NO	製品	寸法 (幅*奥行*高)			個数	才数
1	天板	1000	1000	90	1	3.24
2	前板	320	90	210	2	0.44
3	横板	850	90	210	2	1.16
4	後板	756	90	210	1	0.51
5	四ッ石前後	1000	120	90	2	0.78
6	四ッ石横	120	756	90	2	0.59
7	納骨蓋	390	80	208	1	0.23
図面No. NA000-1743B					11	6.95

No.	1	名称	天板	個数	1	仕上	△全面磨光	No.	2	名称	前板	個数	2	仕上	4面磨
-----	---	----	----	----	---	----	-------	-----	---	----	----	----	---	----	-----

NA000-1743B

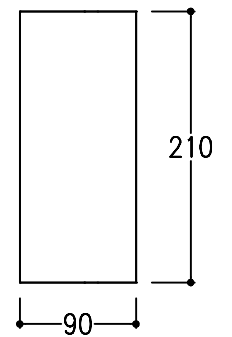
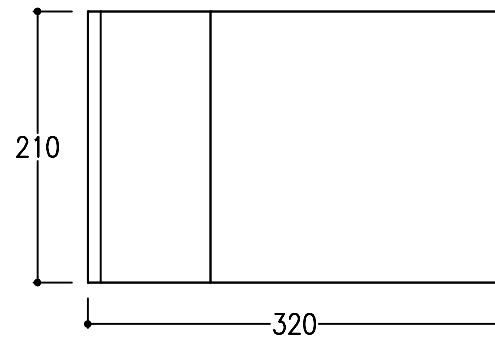
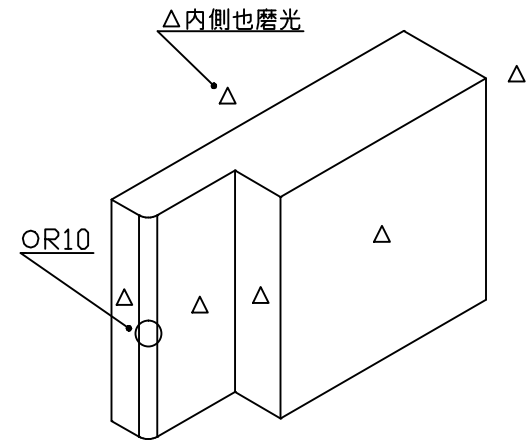
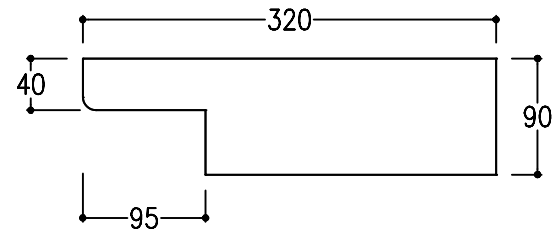
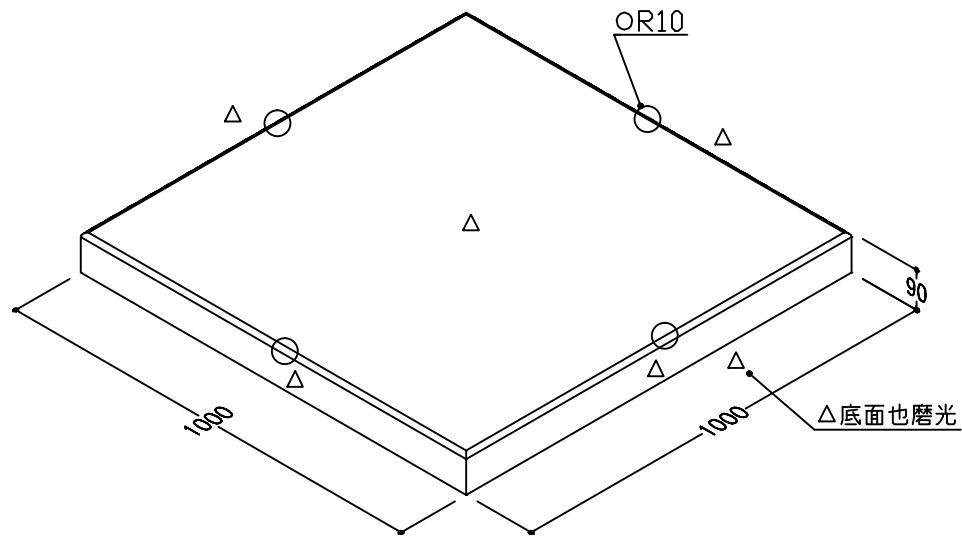

No.	3	名称	横板	個数	2	仕上	3面磨	No.	4	名称	後板	個数	1	仕上	2面磨
-----	---	----	----	----	---	----	-----	-----	---	----	----	----	---	----	-----

NA000-1743B

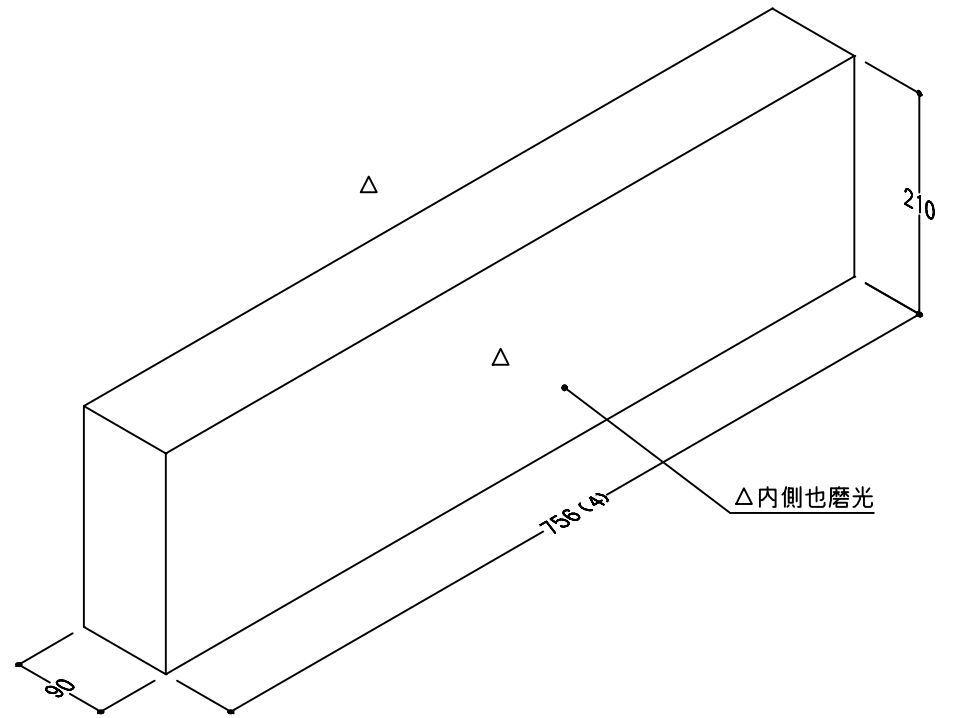
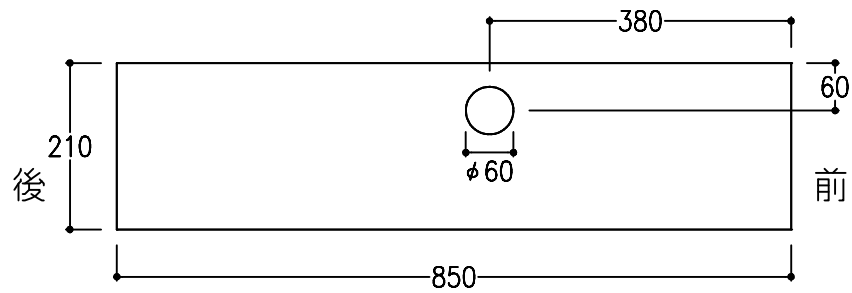
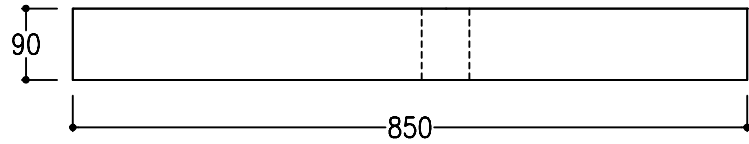
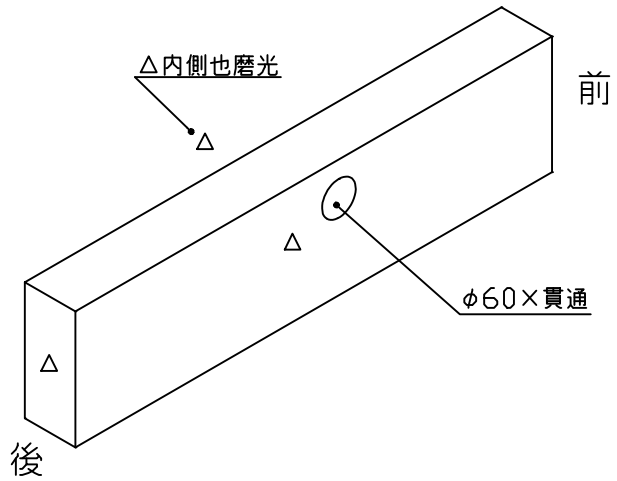

No.	5	名称	四ッ石 (前後)	個数	2	仕上	△底場以外磨光	No.	6	名称	四ッ石 (横)	個数	2	仕上	3面磨
-----	---	----	----------	----	---	----	---------	-----	---	----	---------	----	---	----	-----

NA000-1743B

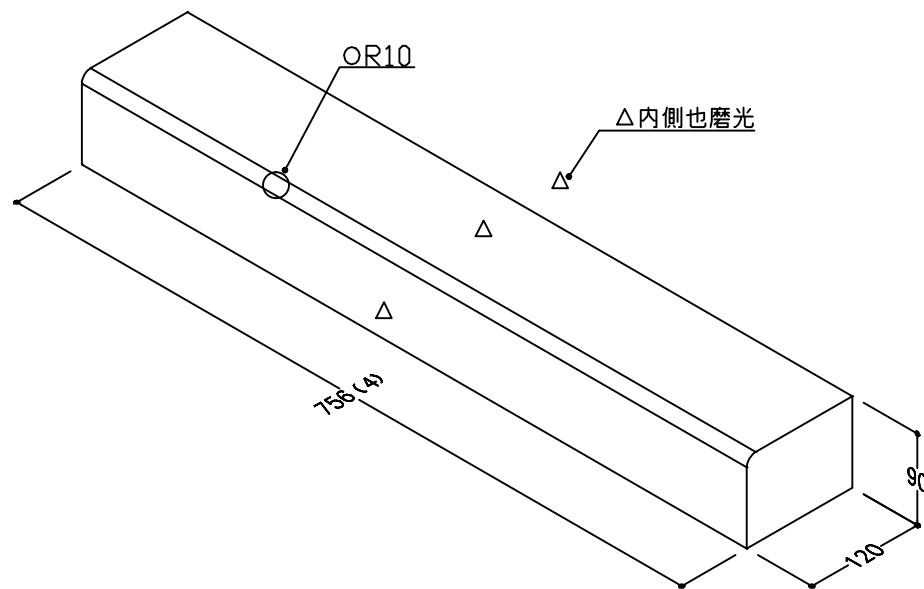
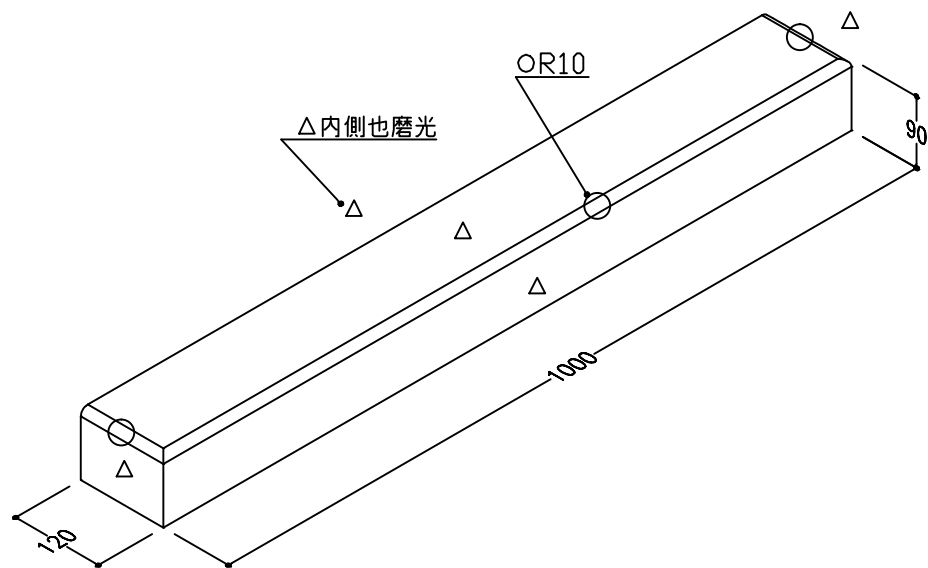

No.	7	名称	納骨蓋	個数	1	仕上	△全面磨光
-----	---	----	-----	----	---	----	-------

NA000-1743B

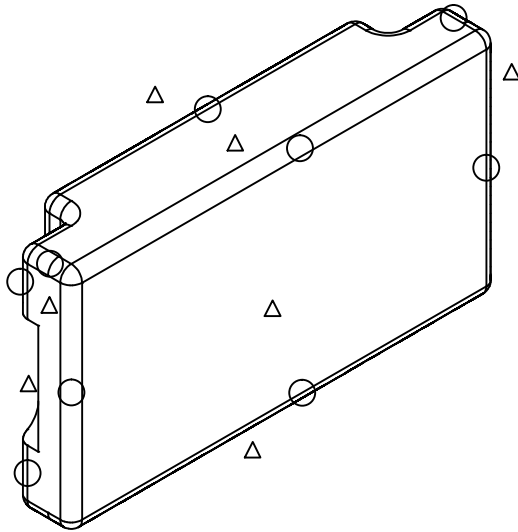
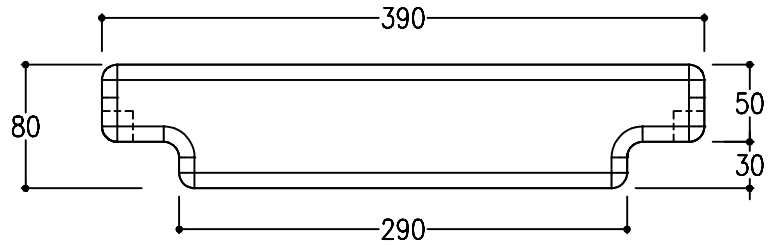

○印 全辺R10

