

和
 < NAGOMI >

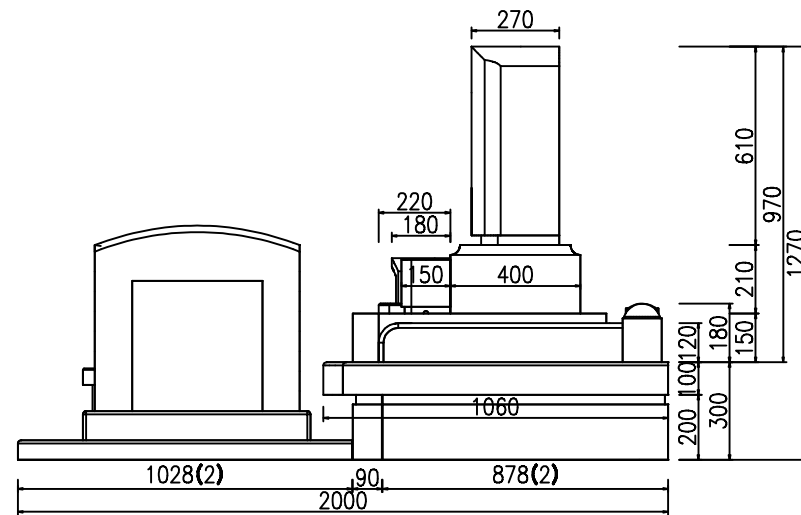

和
 < NAGOMI >

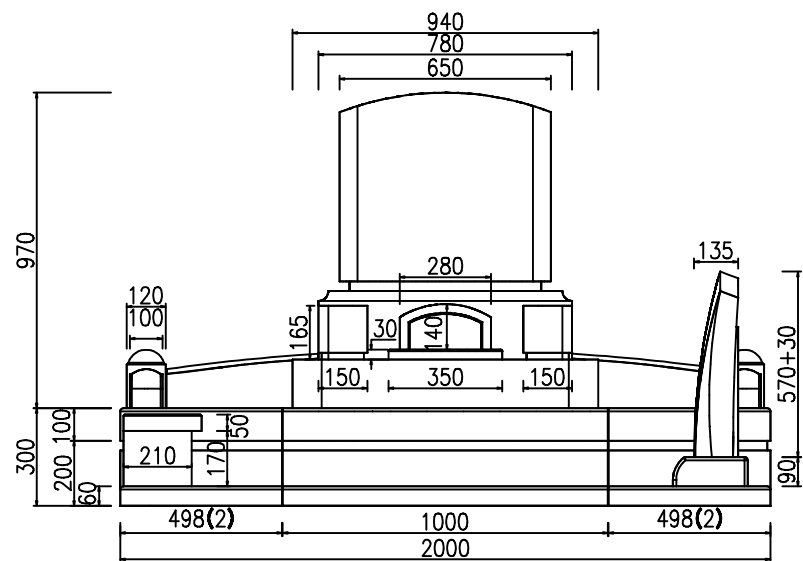
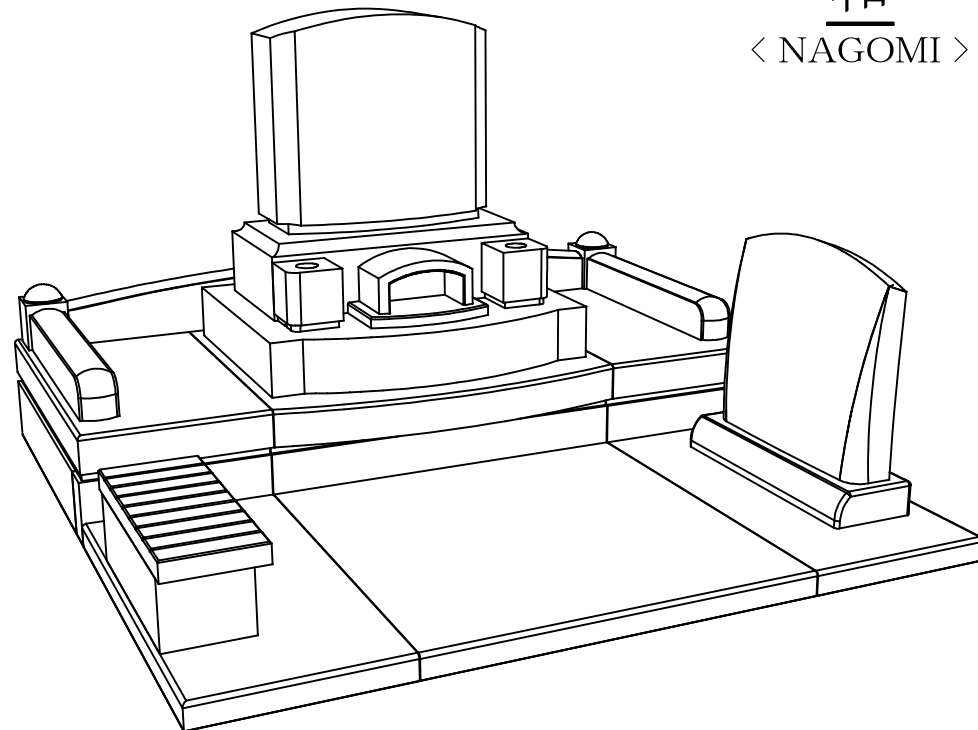
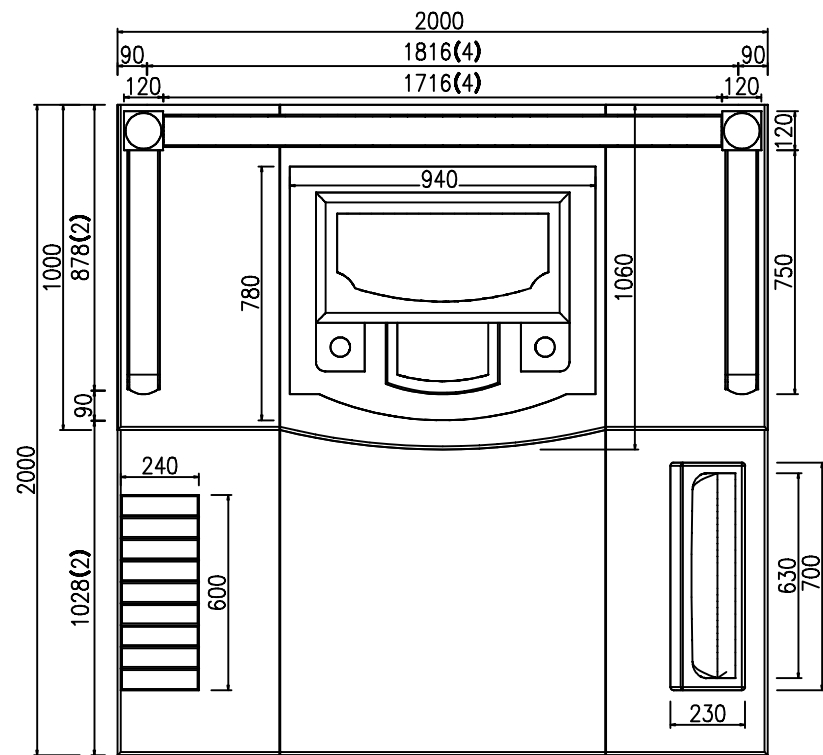
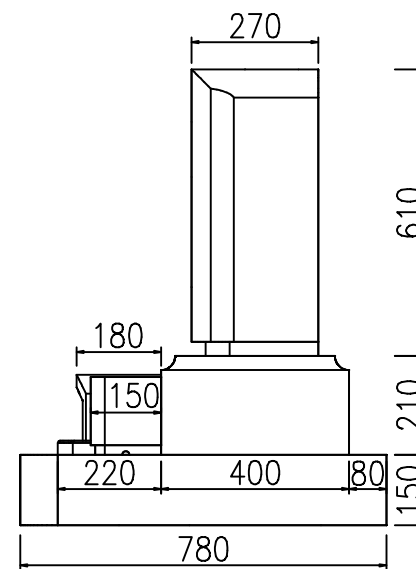
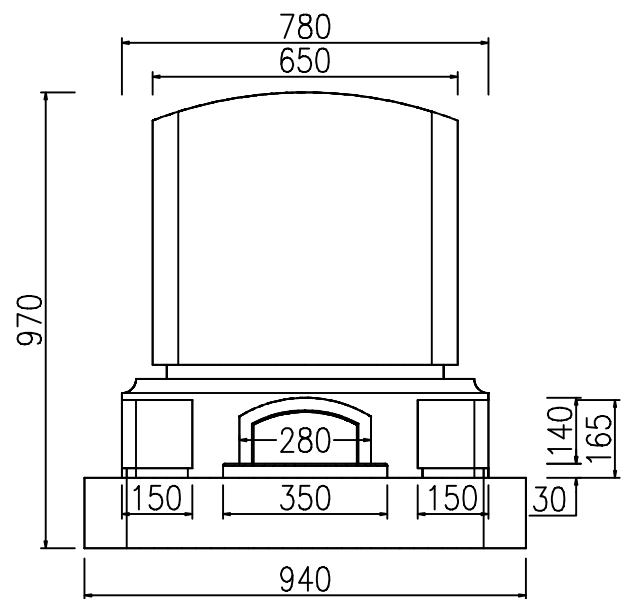
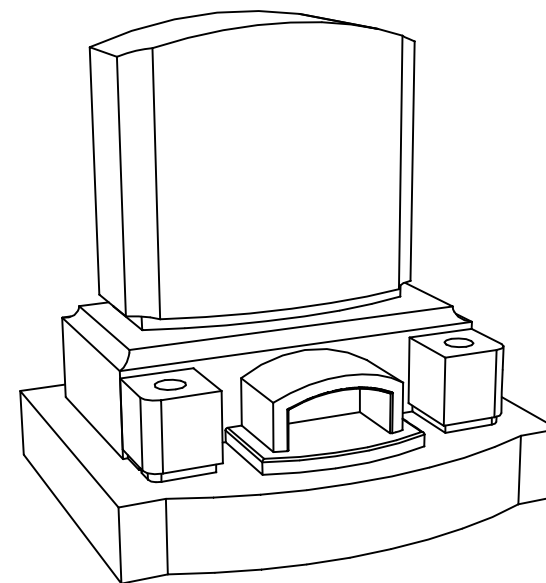
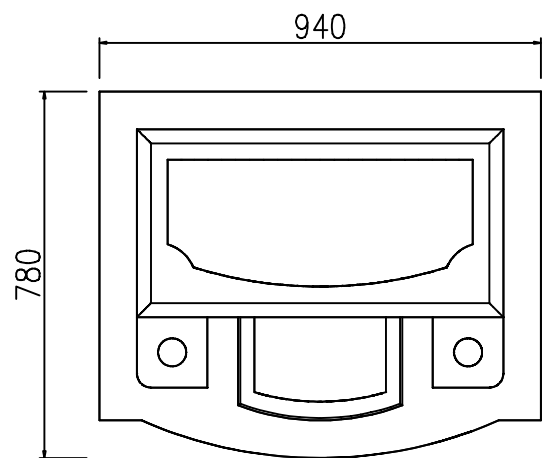

和
 < NAGOMI >

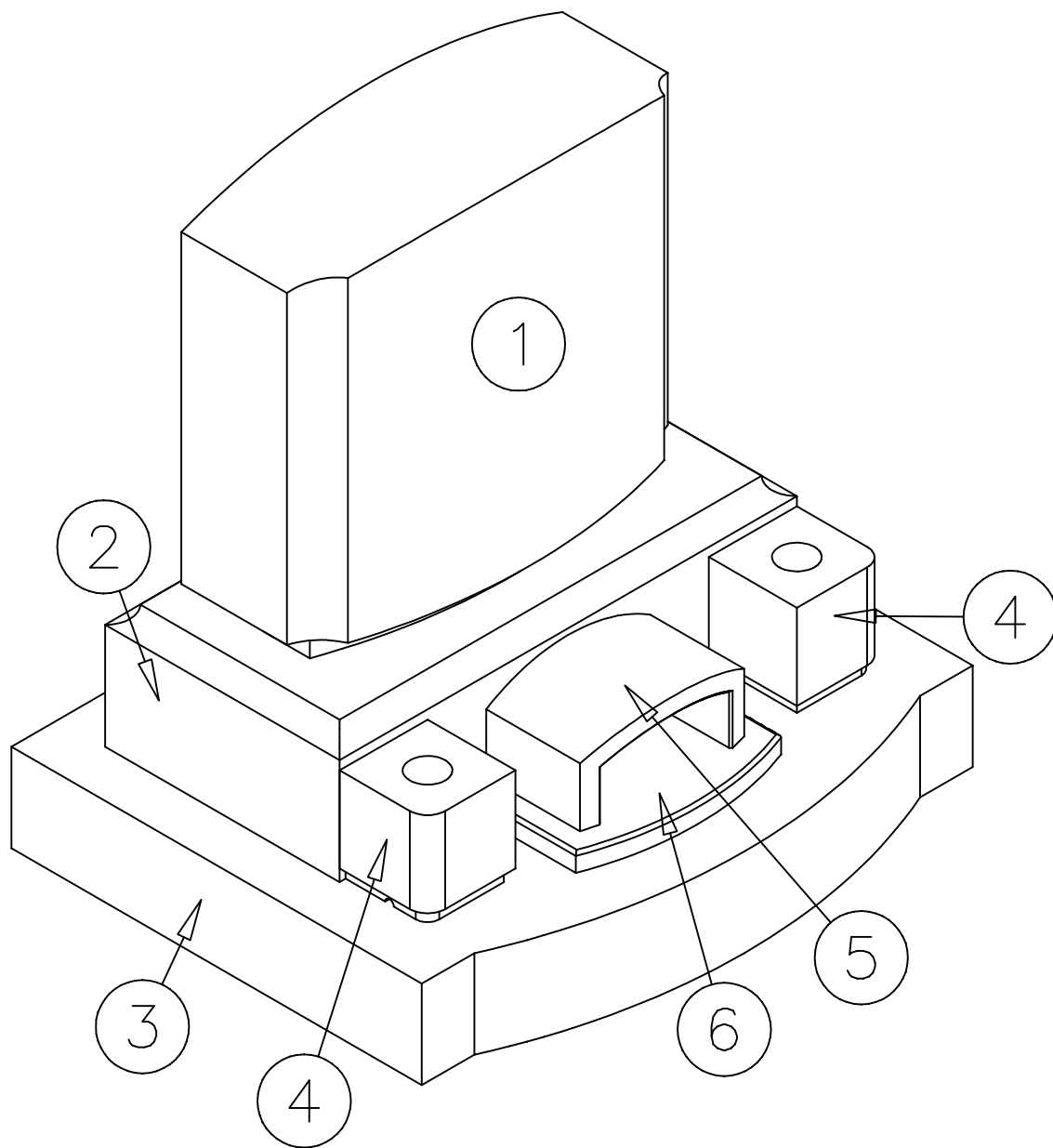

NO	製品	寸法(幅*奥行*高)			個数	才数
1	竿石	650	270	610	1	3.85
2	上台	780	400	210	1	2.36
3	芝台	940	780	150	1	3.96
4	花立	150	150	165	2	0.27
5	香炉	280	180	140	1	0.25
6	香炉台	350	220	30	1	0.08
図面No. C-4675					7	10.77

No.	1	名称	竿石	個数	1	仕上	△底場以外磨光	No.	2	名称	上台	個数	1	仕上	△底場以外磨光
C-4675		加工書													

No.	3	名称	芝台	個数	1	仕上	△底場以外磨光
-----	---	----	----	----	---	----	---------

C-4675 加工書

No.	5	名称	香炉	個数	1	仕上	△底場以外磨光
-----	---	----	----	----	---	----	---------

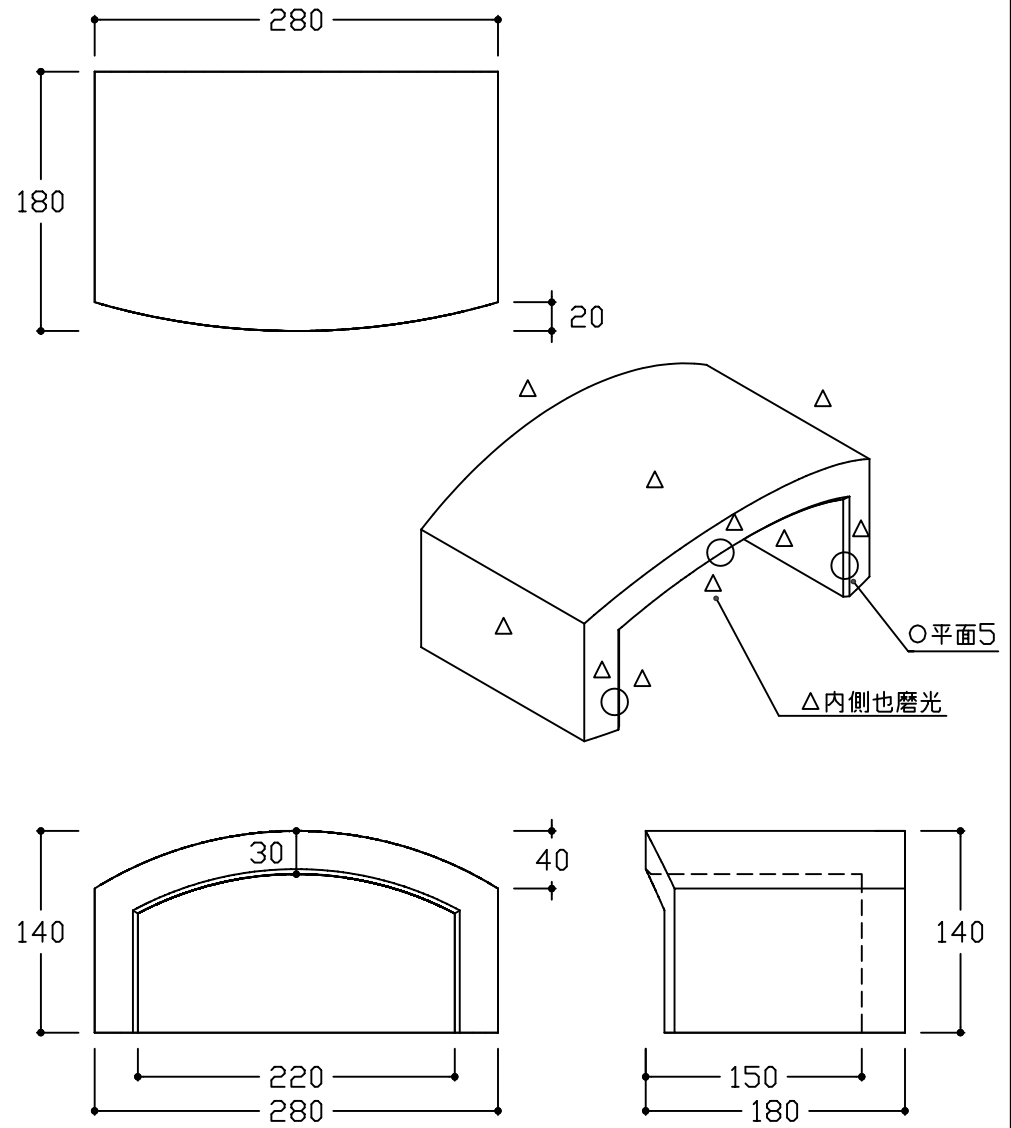
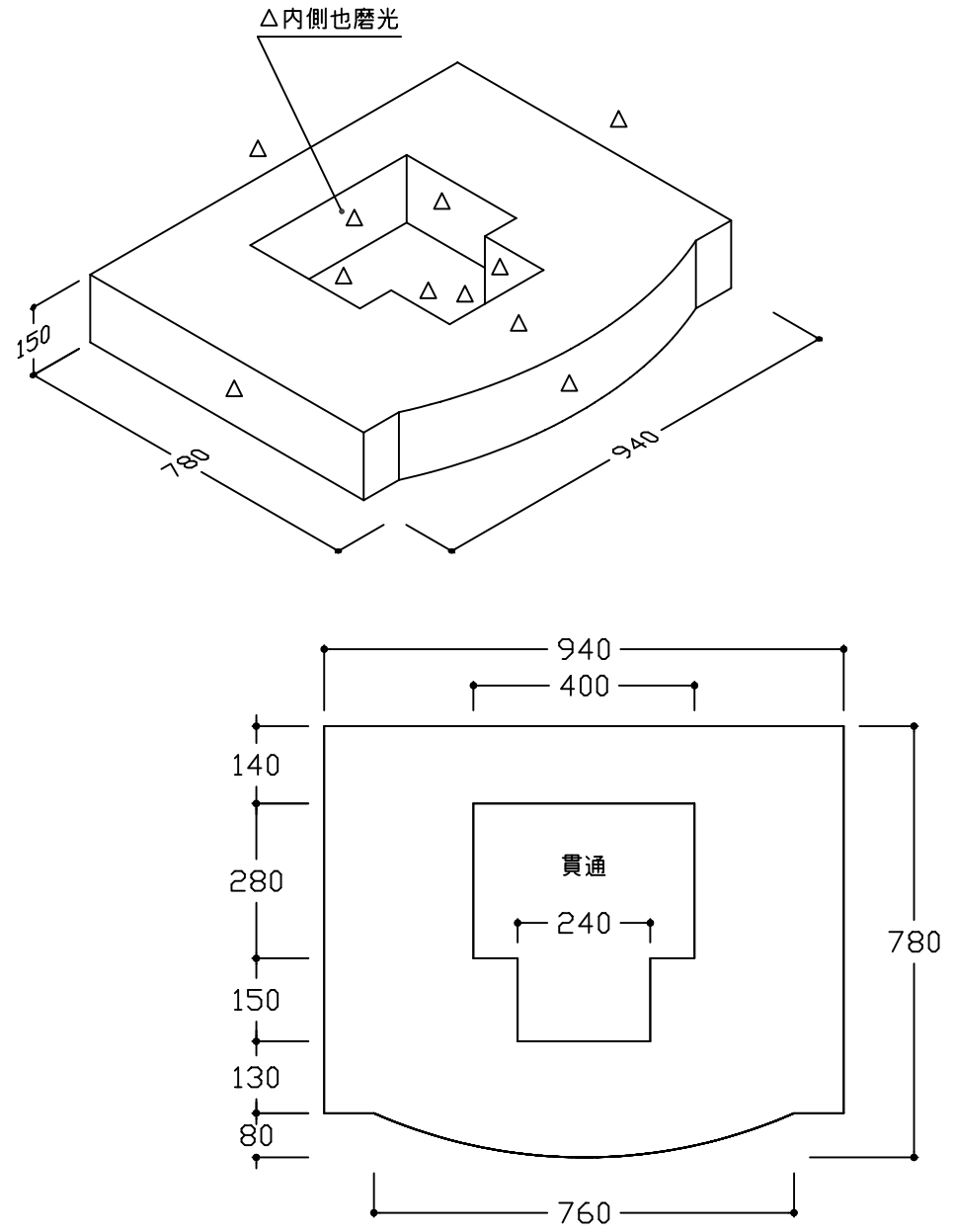

No. 4

名称

花立(左)

個数

1

仕上

△底場以外磨光

C-4675 加工書

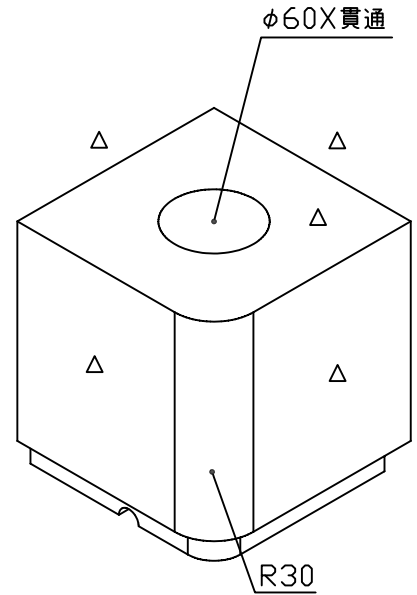
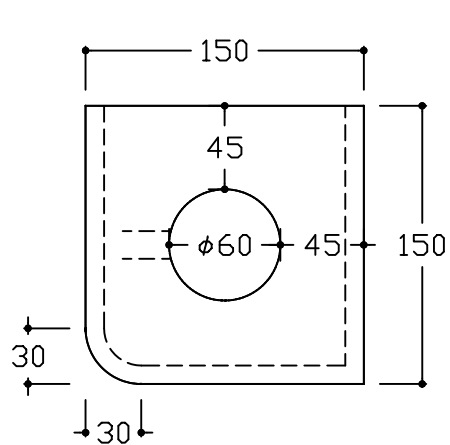

No. 4

名称

花立(右)

個数

1

仕上

△底場以外磨光

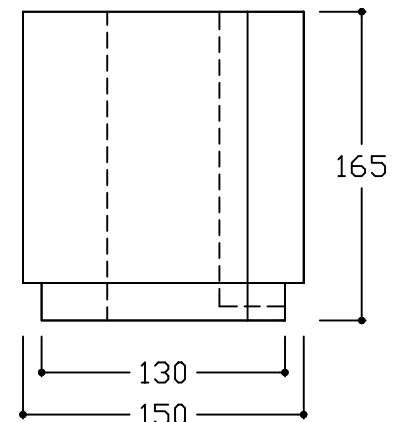
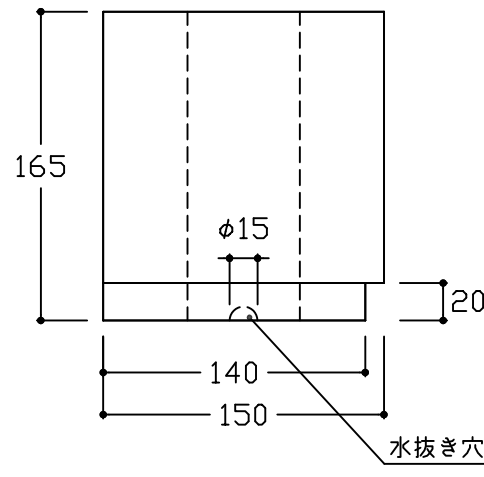
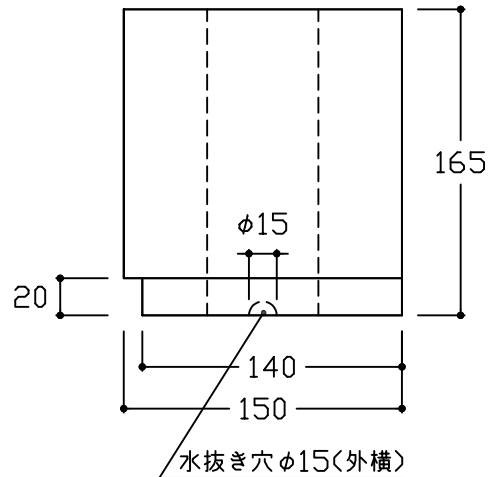
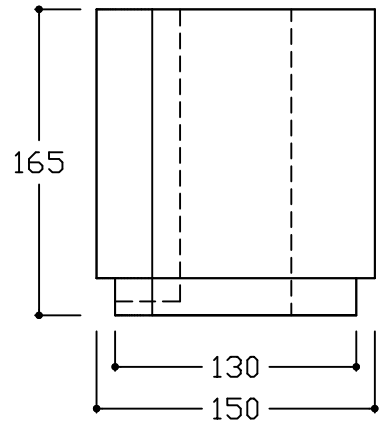
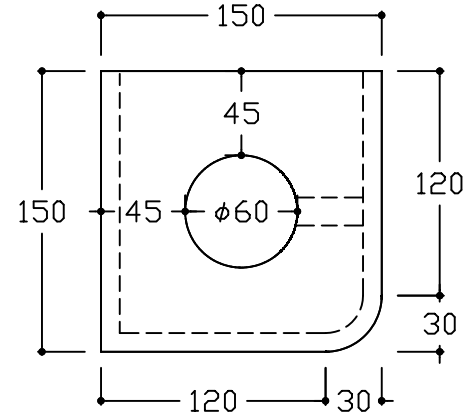
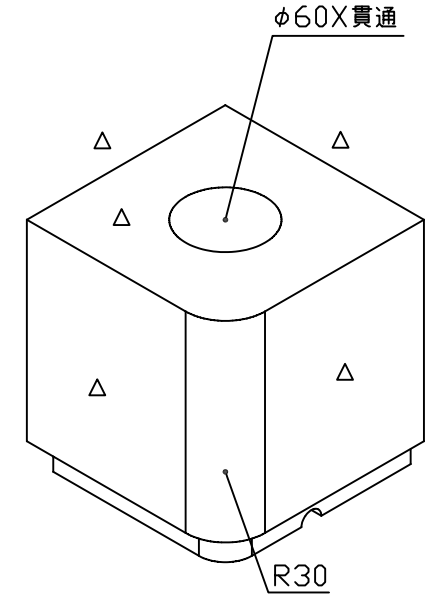

No.	6	名称	香炉台	個数	1	仕上	△底場以外磨光	No.	名称	個数	仕上	
C-4675 加工書												
<p>The drawing shows a rectangular incense burner with a curved front edge. The top view shows a width of 220 and a length of 350. The side view shows a thickness of 30. The front edge has a radius of 32. There are three circular holes on the top surface, with the top-right one labeled 'OR5'. Small triangles (△) are placed at the corners and along the edges, indicating areas to be polished. The finish specification is '△底場以外磨光' (Polish all areas except the bottom field).</p>												

和
 < NAGOMI >

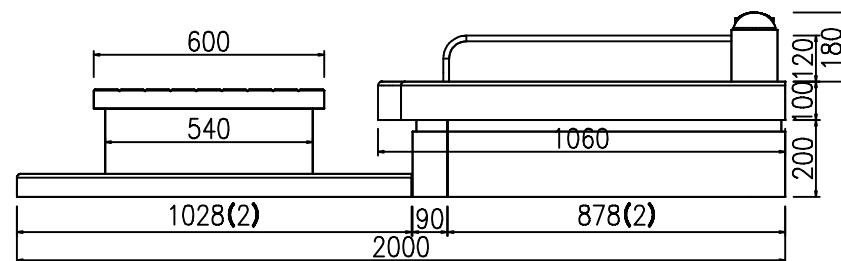
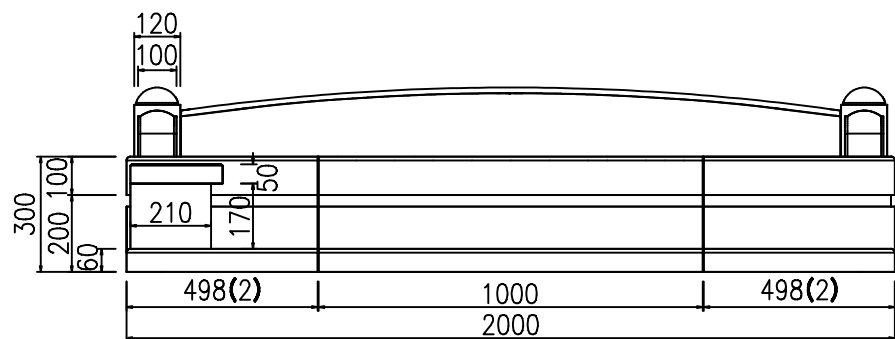
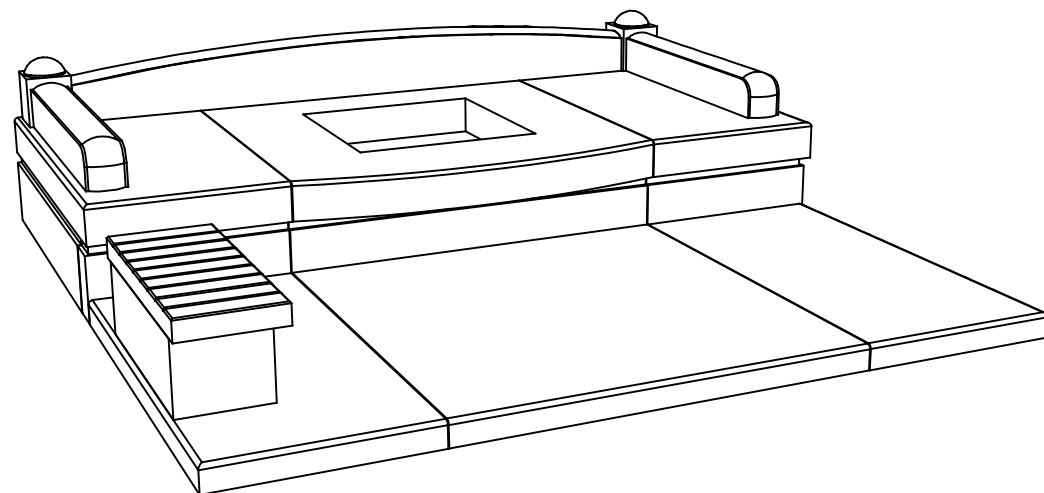
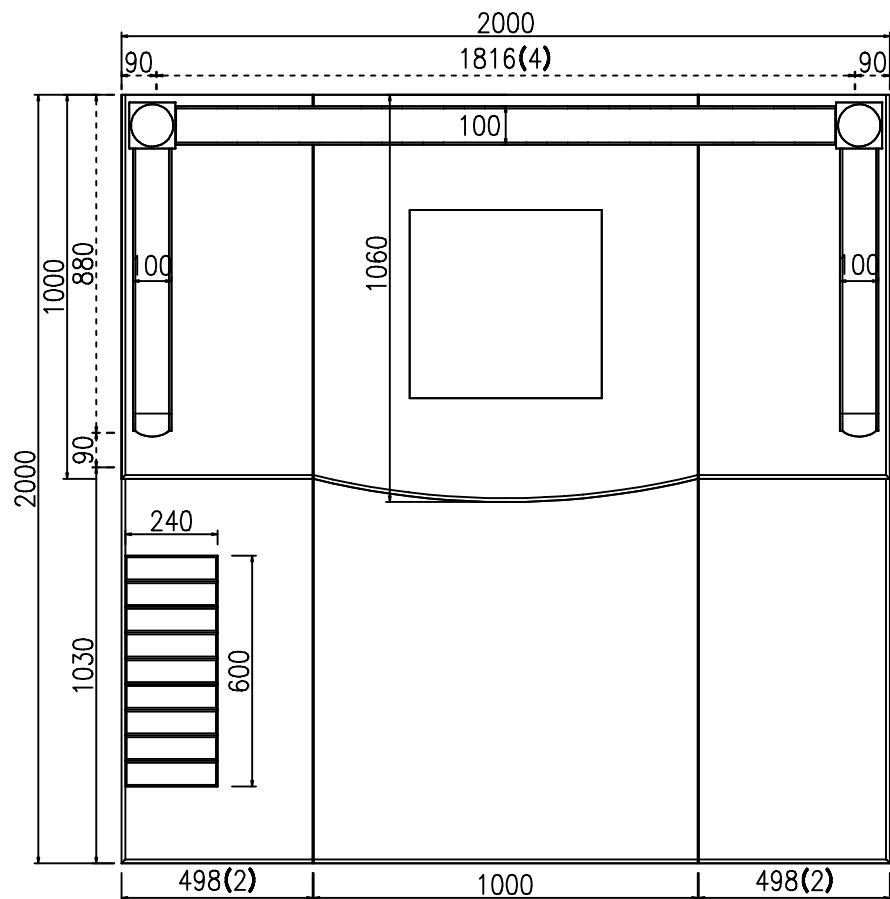

和
 < NAGOMI >

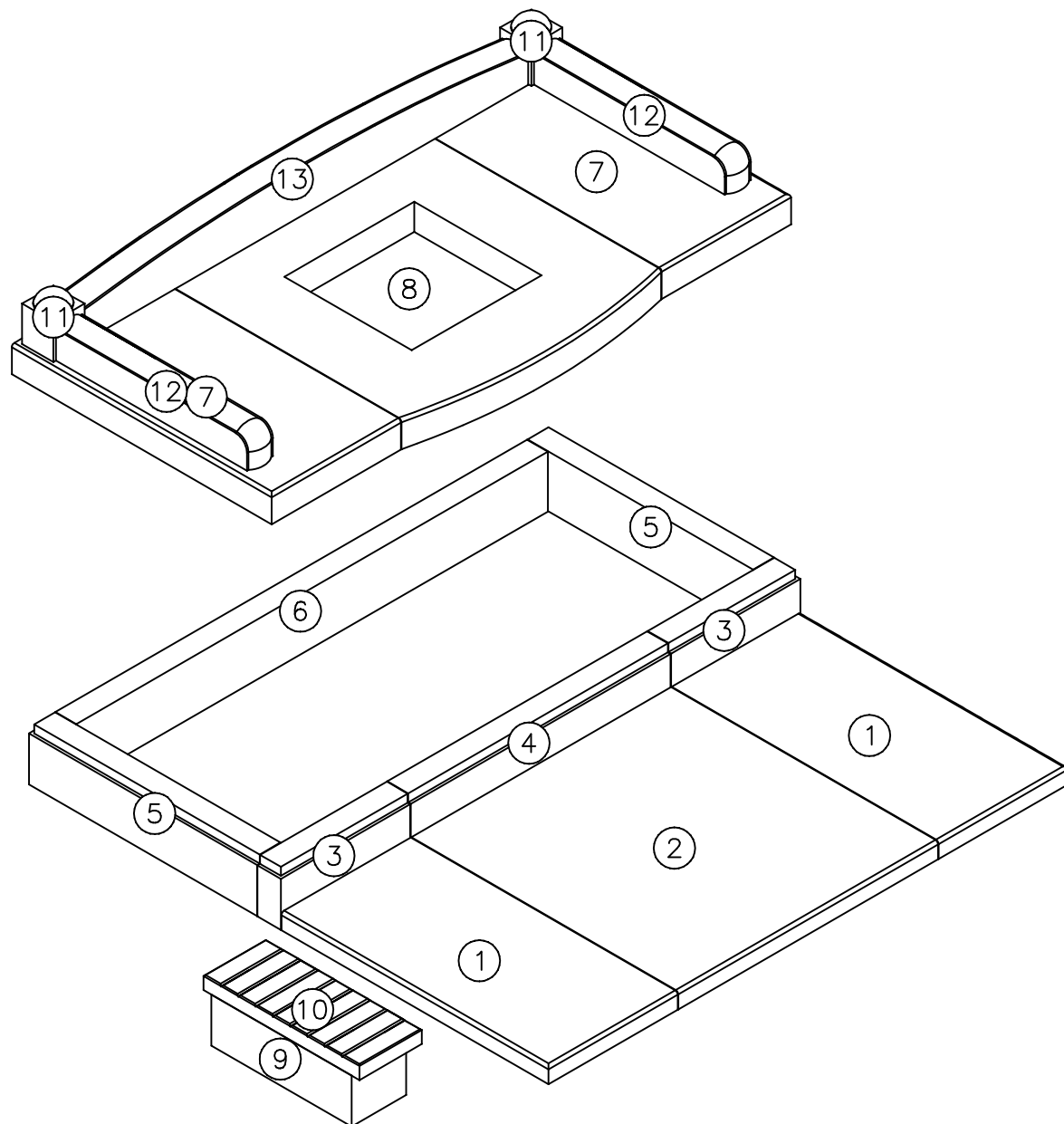

別石種：①～⑨
 ⑩～⑬

NO	製品	寸法(幅*奥行*高)			個数	才数
1	階段	498	1028	60	2	2.21
2	階段	1000	1028	60	1	2.22
3	中仕切	498	90	200	2	0.65
4	中仕切	1000	90	200	1	0.65
5	巻石横	90	878	200	2	1.14
6	巻石後	1816	90	200	1	1.18
7	天板	498	1000	100	2	3.59
8	天板	1000	1060	100	1	3.82
9	ベンチ台	210	540	170	1	0.69
図面No. C-4607					13	16.15

NO	製品	寸法(幅*奥行*高)			個数	才数
10	ベンチ天板	240	600	50	1	0.26
11	小柱	120	120	180	2	0.19
12	横玉垣	100	750	120	2	0.65
13	後玉垣	1716	100	180	1	1.11
図面No. C-4607					6	2.21

No.	1	名称	階段 (左)	個数	1	仕上	3面磨
-----	---	----	--------	----	---	----	-----

C-4607 加工書

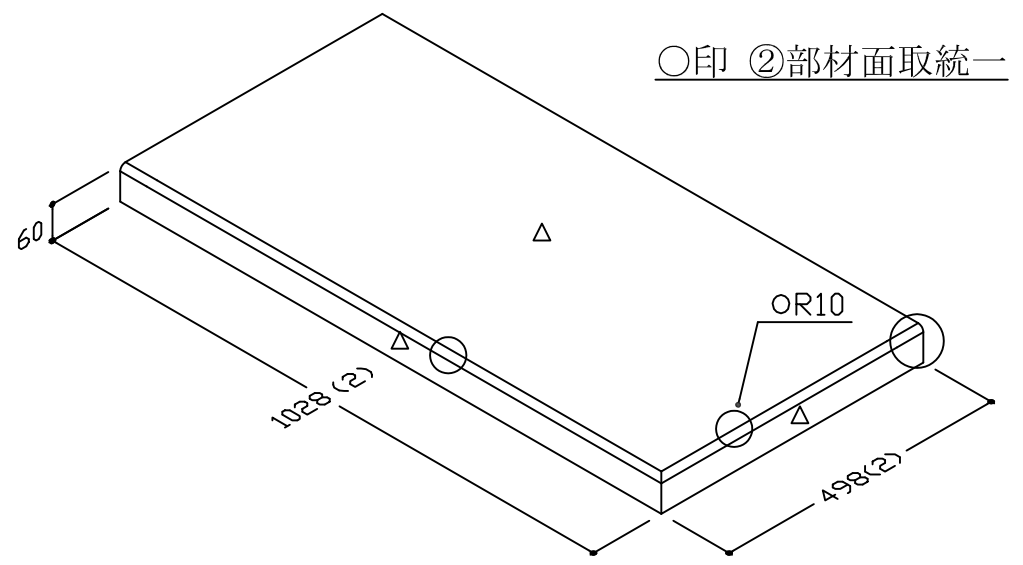

No.	1	名称	階段 (右)	個数	1	仕上	3面磨
-----	---	----	--------	----	---	----	-----

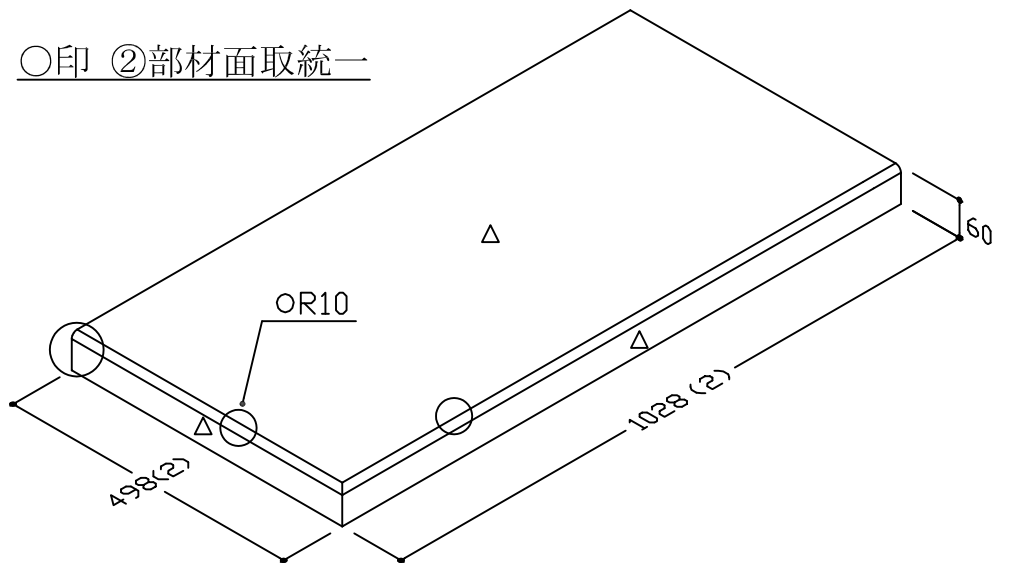

No.	2	名称	階段	個数	1	仕上	2面磨
-----	---	----	----	----	---	----	-----

C-4607 加工書

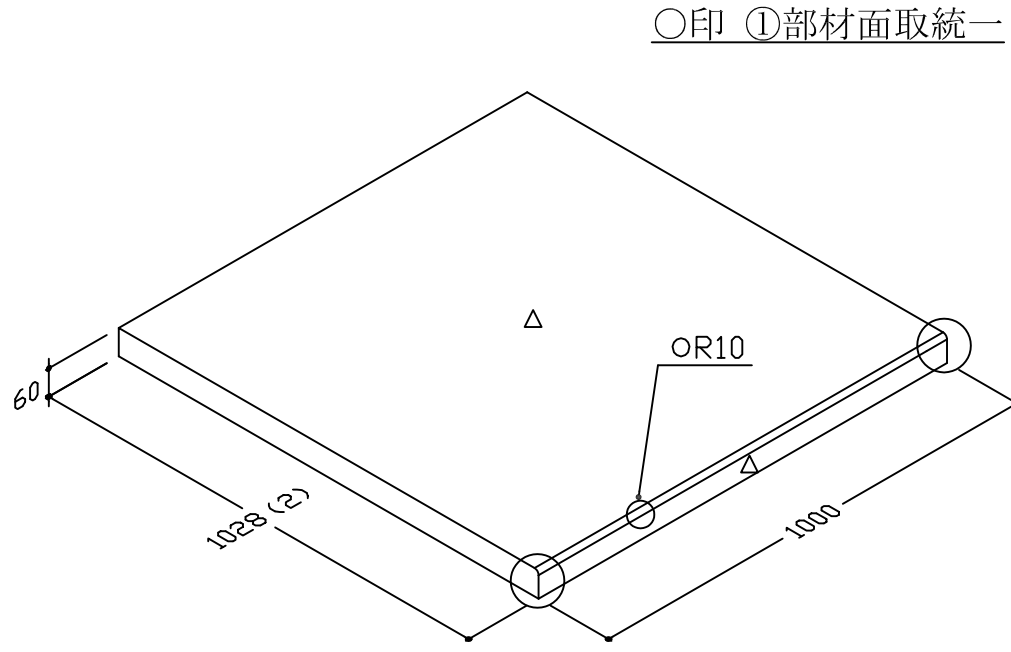

No.	4	名称	中仕切	個数	2	仕上	2面磨
-----	---	----	-----	----	---	----	-----

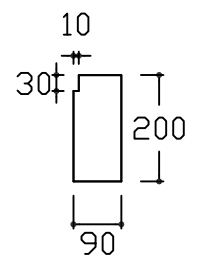
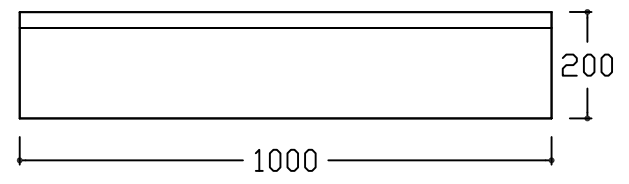
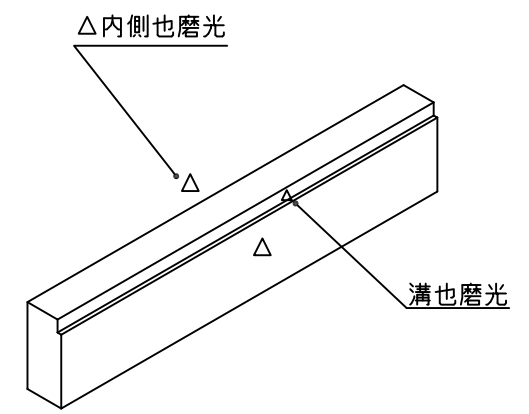
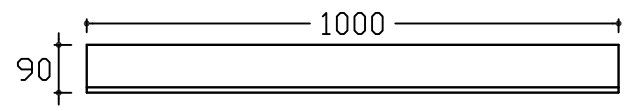

No.	3	名称	中仕切	個数	1	仕上	3面磨
-----	---	----	-----	----	---	----	-----

C-4607 加工書

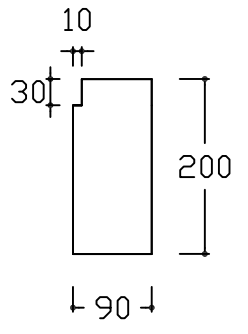
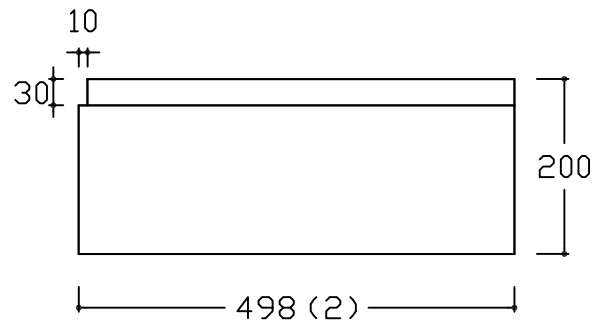
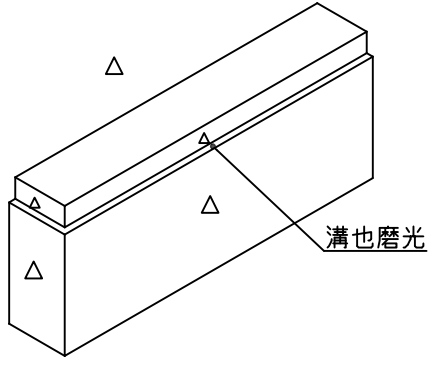
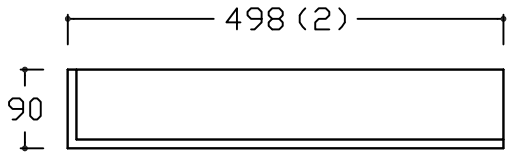

No.	3	名称	中仕切	個数	1	仕上	3面磨
-----	---	----	-----	----	---	----	-----

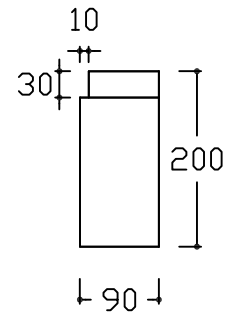
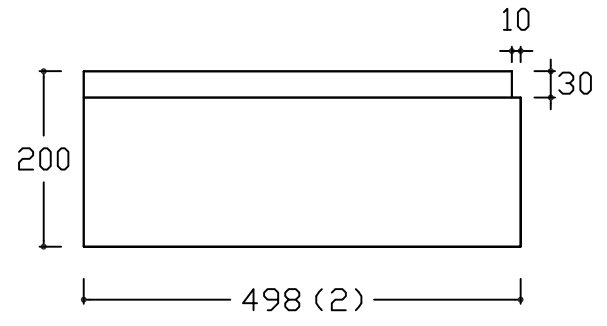
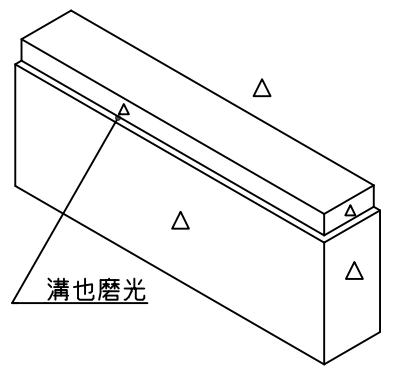
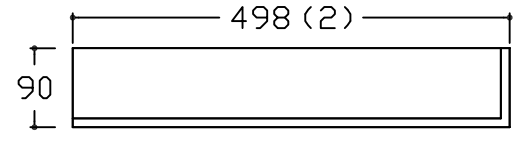

No.	5	名称	卷石横	个数	1	仕上	3面磨
-----	---	----	-----	----	---	----	-----

C-4607 加工書

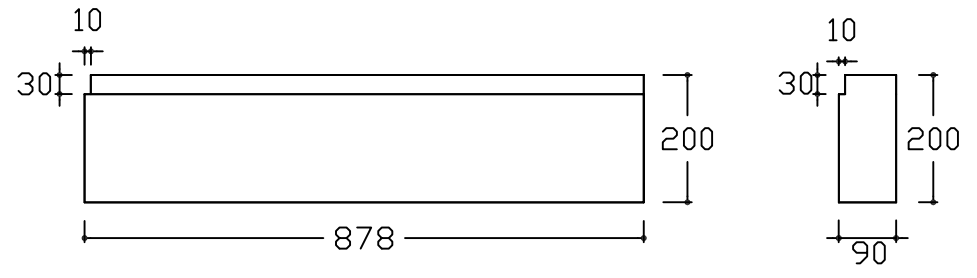
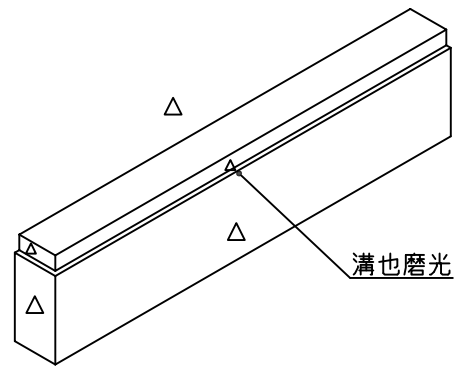
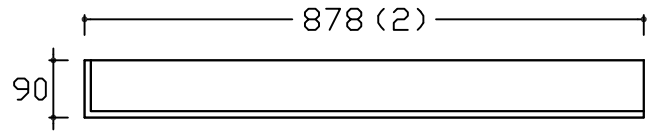

No.	5	名称	卷石横	个数	1	仕上	3面磨
-----	---	----	-----	----	---	----	-----

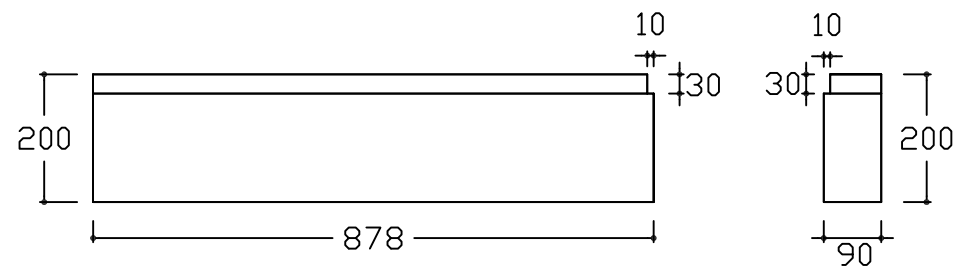
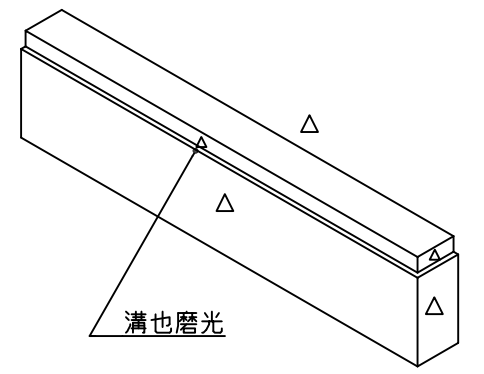
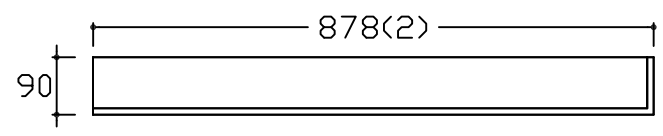

No.	6	名称	卷石後	個数	1	仕上	3面磨
-----	---	----	-----	----	---	----	-----

C-4607 加工書

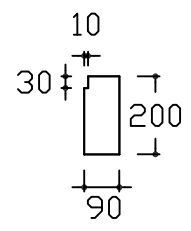
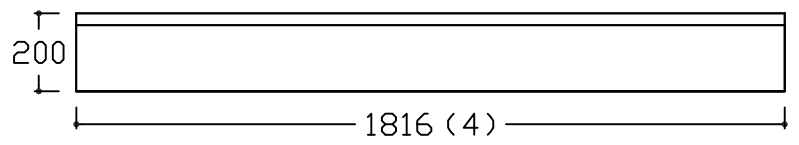
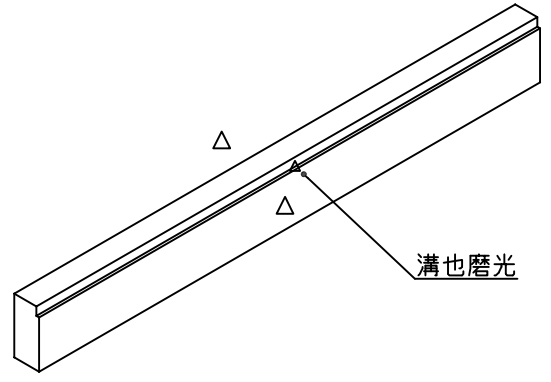
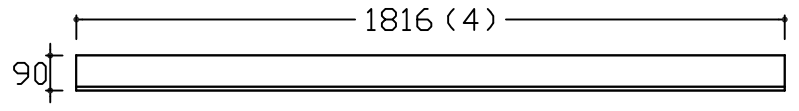

No.	8	名称	天板	個数	1	仕上	4面磨
-----	---	----	----	----	---	----	-----

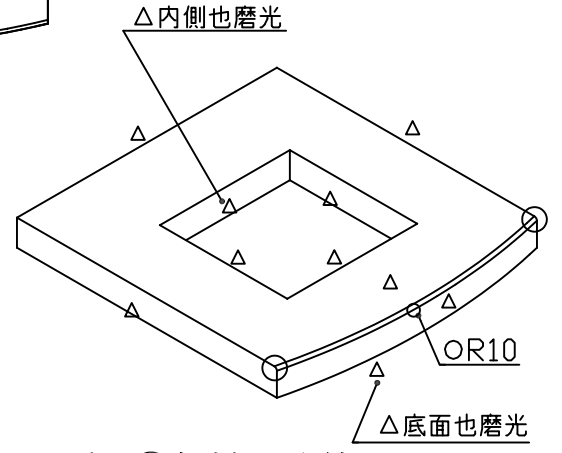
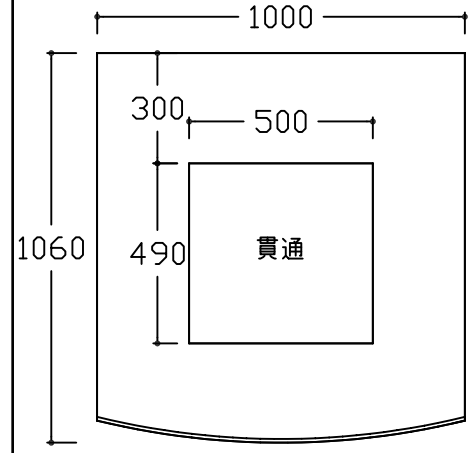

○印 ⑦部材面取統一

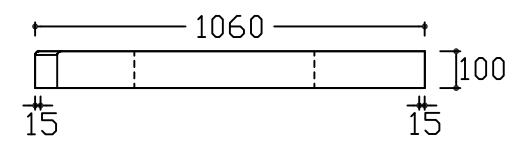
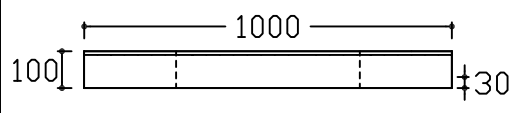

No.	7	名称	天板 (左)	個数	1	仕上	5面磨
-----	---	----	--------	----	---	----	-----

C-4607 加工書

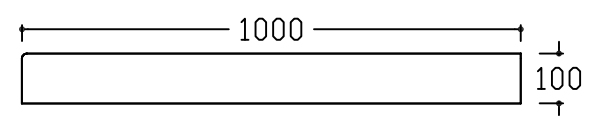
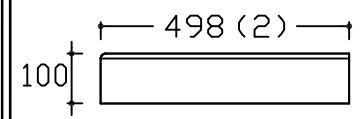
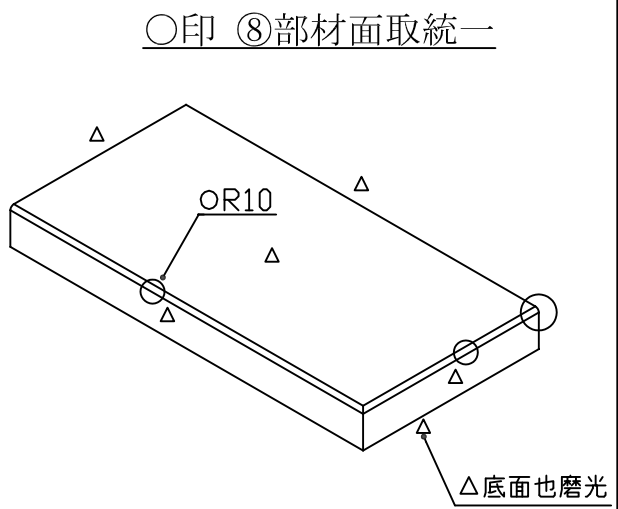
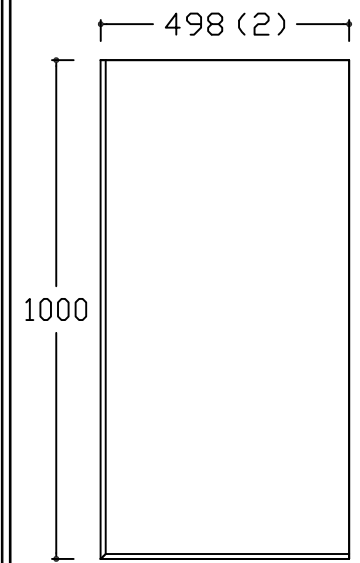

No.	7	名称	天板 (右)	個数	1	仕上	5面磨
-----	---	----	--------	----	---	----	-----

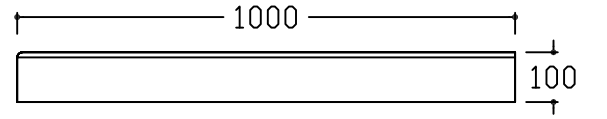
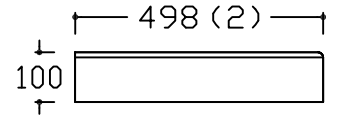
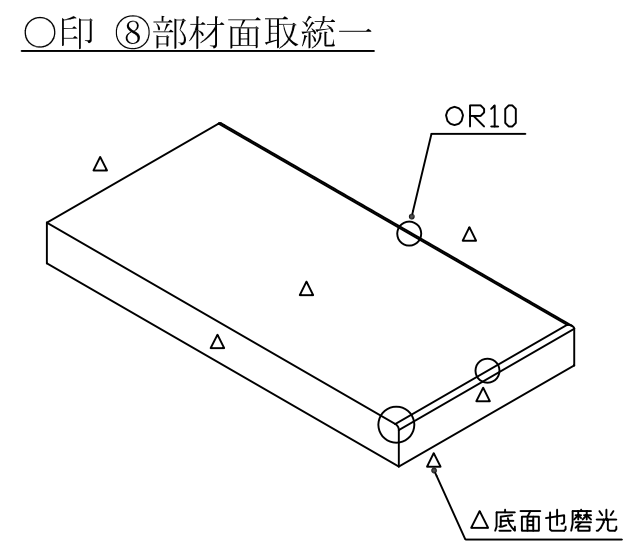
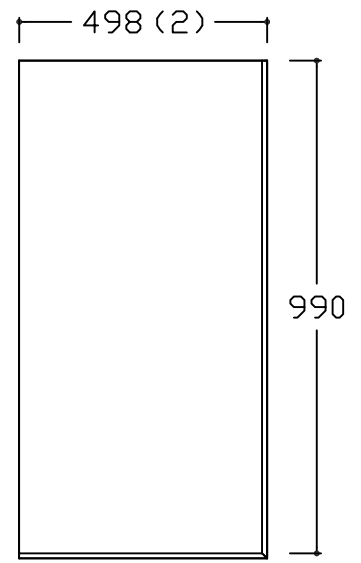

No.	9	名称	ベンチ台	個数	1	仕上	4面磨	No.		名称		個数		仕上	
-----	---	----	------	----	---	----	-----	-----	--	----	--	----	--	----	--

C-4607 加工書

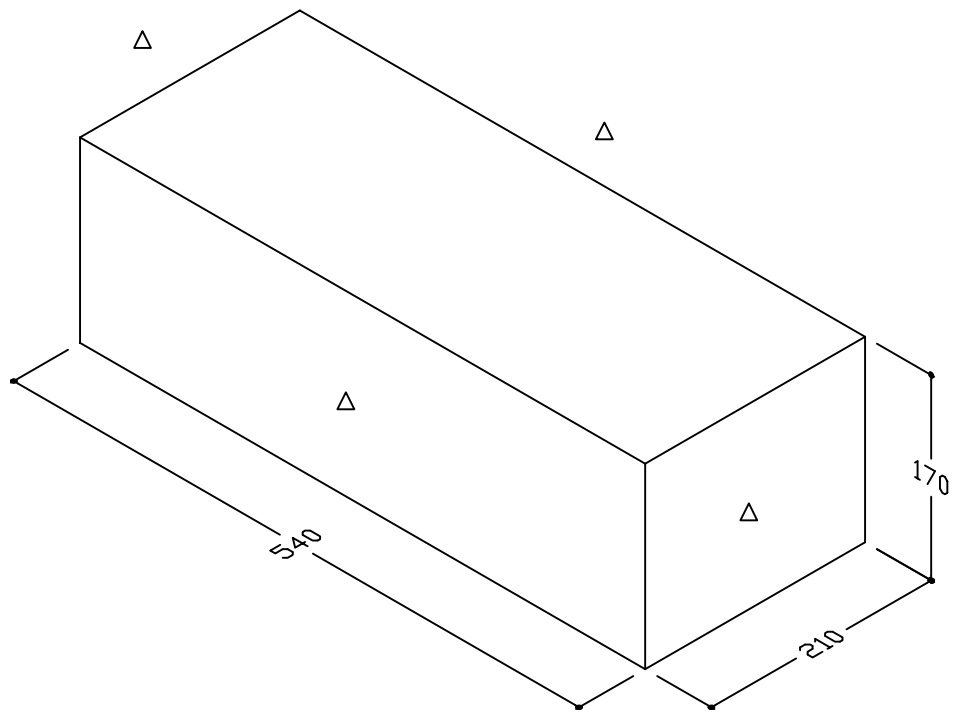

No.	10	名称	ベンチ天板	個数	1	仕上	△全面磨光
-----	----	----	-------	----	---	----	-------

C-4607 加工書

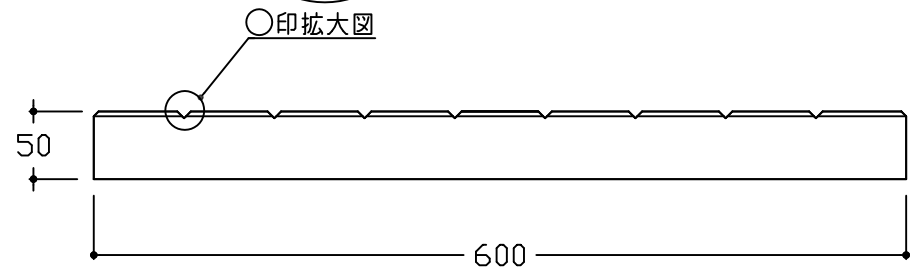
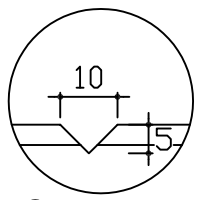
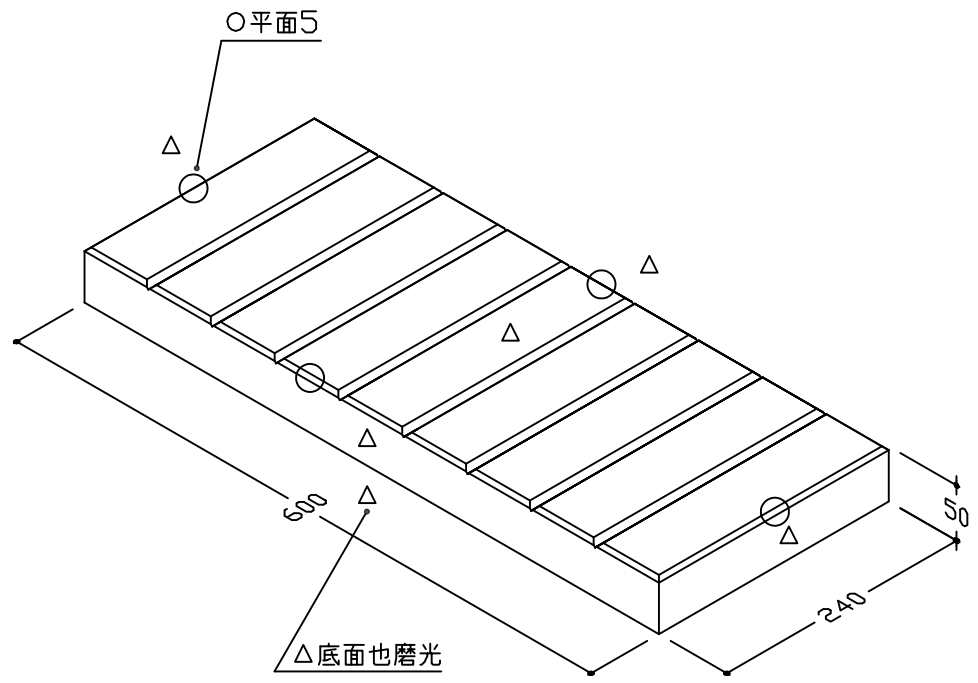

No.	11	名称	小柱	個数	2	仕上	△底場以外磨光
-----	----	----	----	----	---	----	---------

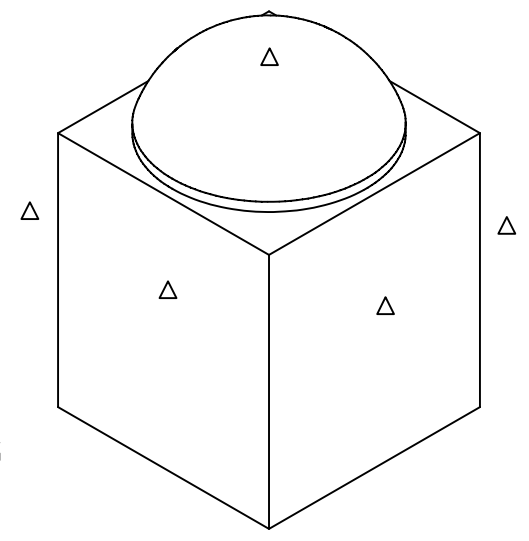
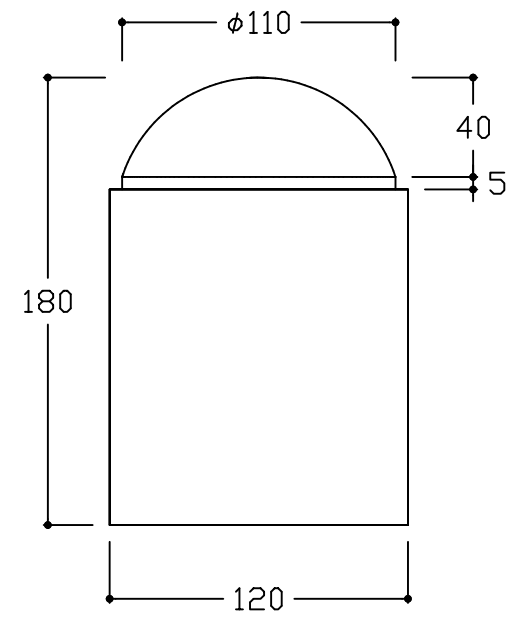
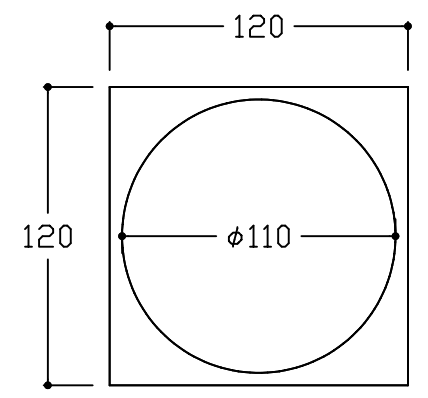

No.	12	名称	横玉垣	个数	2	仕上	4面磨
-----	----	----	-----	----	---	----	-----

C-4607 加工書

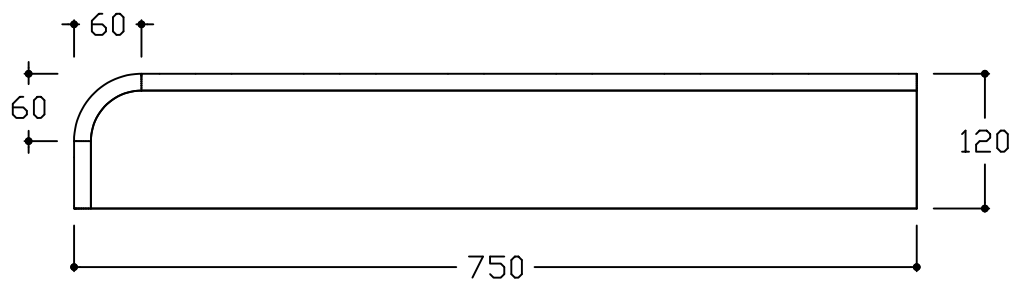
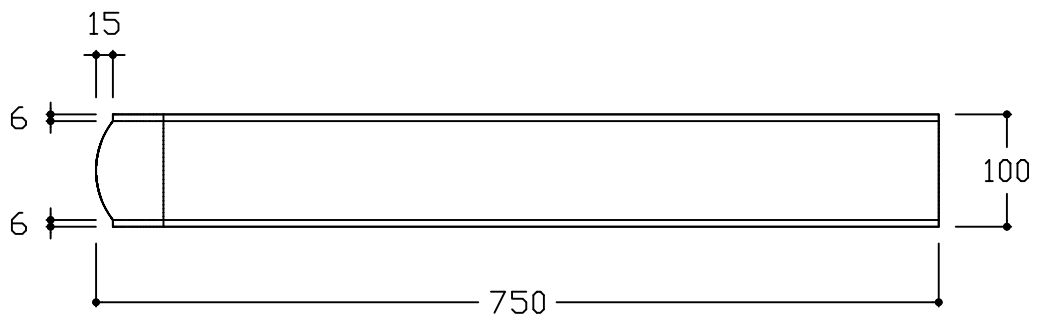
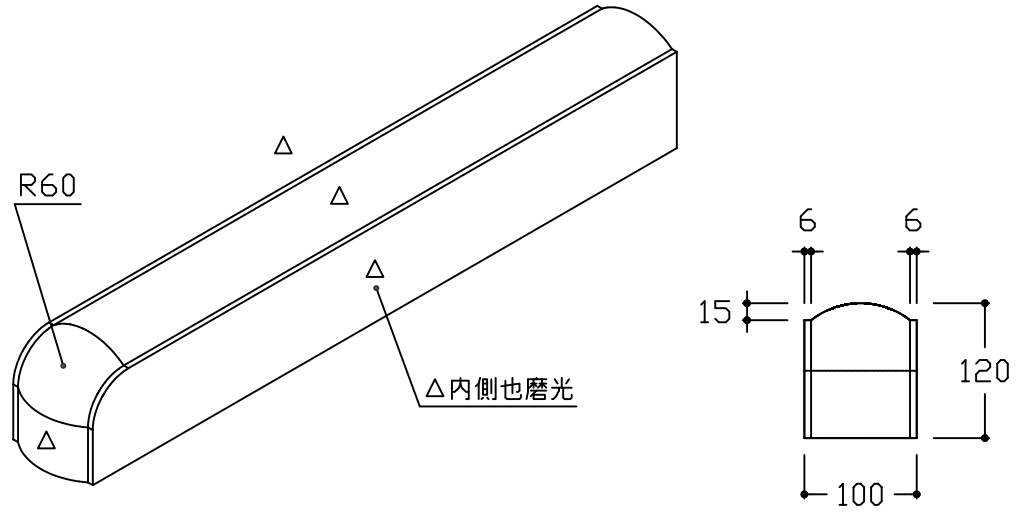

No.	13	名称	後玉垣	个数	1	仕上	3面磨
-----	----	----	-----	----	---	----	-----

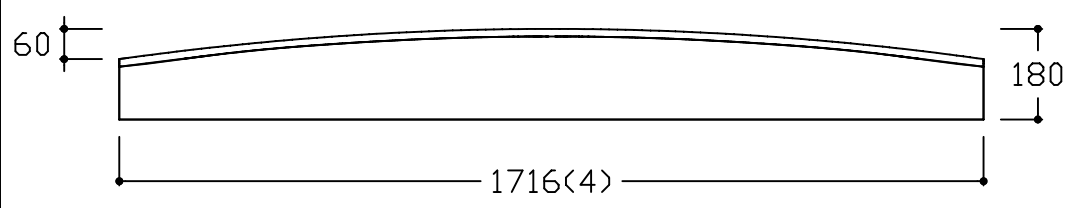
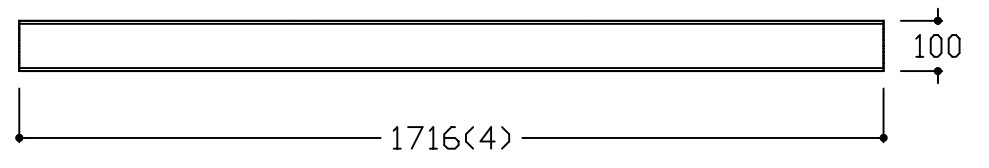
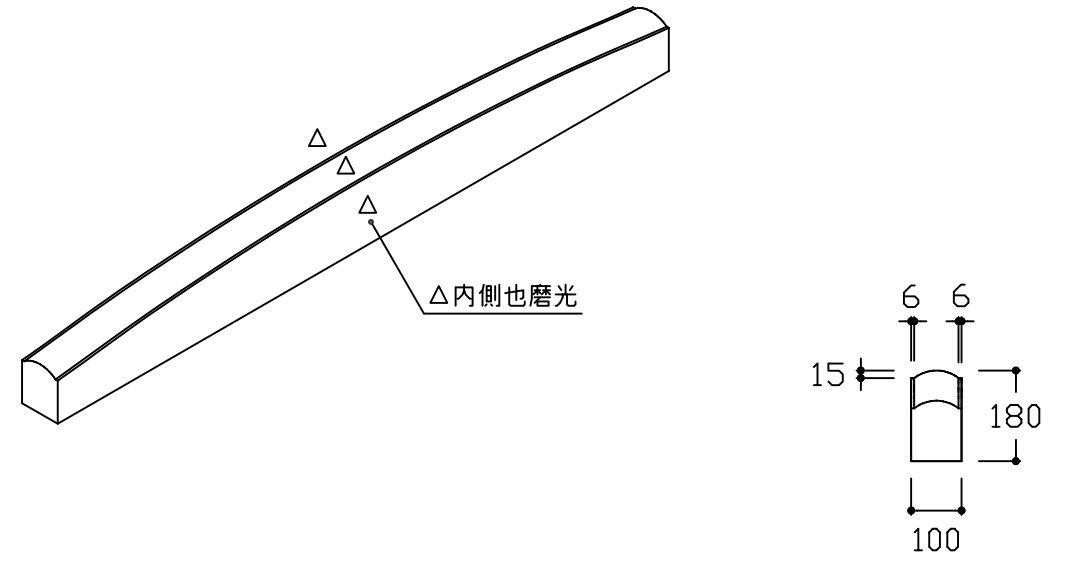

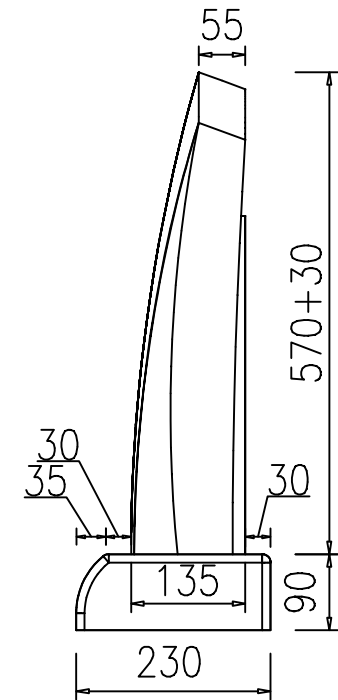
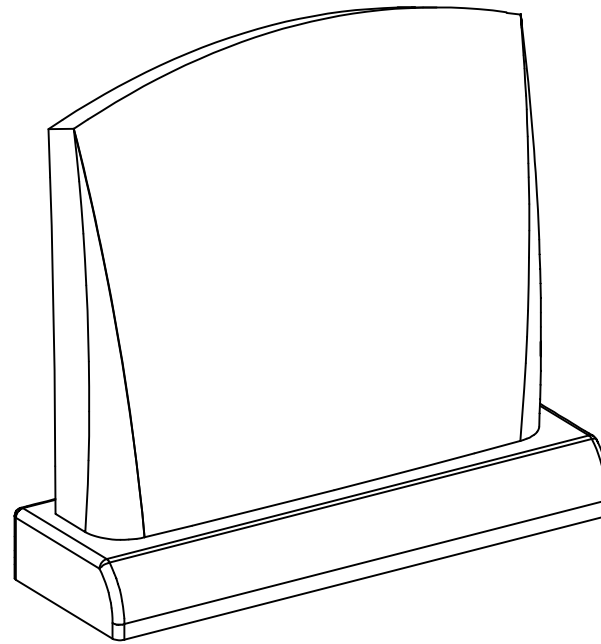
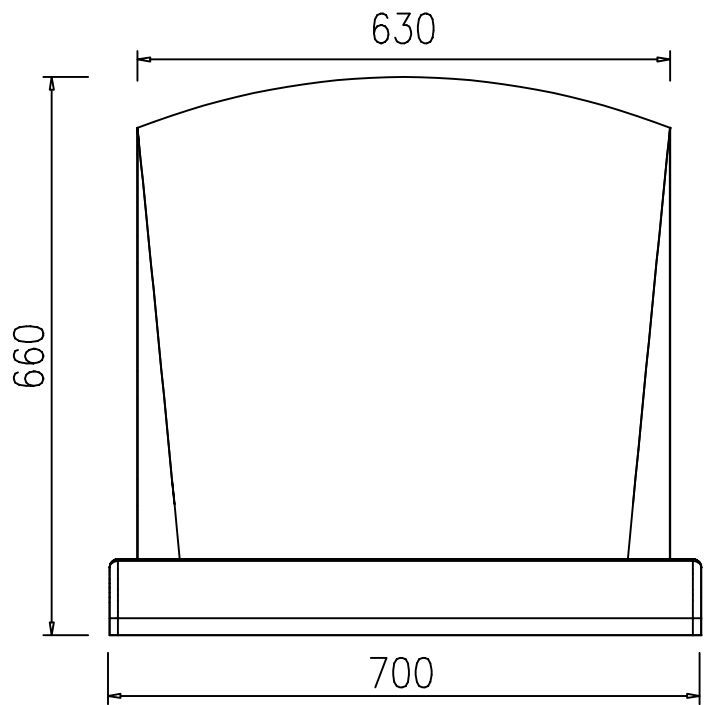
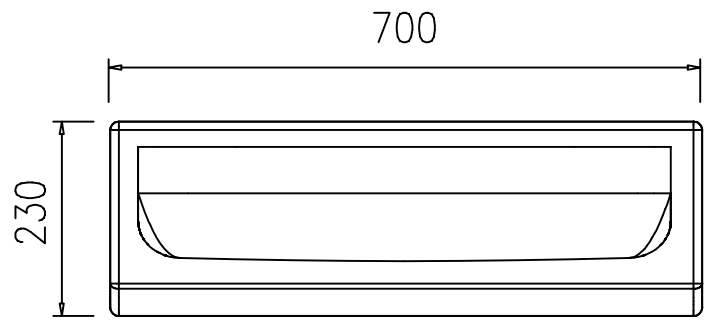

NO	製品	寸法(幅*奥行*高)			個数	才数
		幅	奥行	高		
1	霊標(頭)	630	135	600	1	1.84
2	霊標(台)	700	230	90	1	0.52
図面No. C-4514					2	2.36

No.	1	名称	靈標(頭)	個数	1	仕上	△底場以外磨光	No.	2	名称	靈標(台)	個数	1	仕上	△底場以外磨光
C-4514 加工書															